

## 400 4-Side SSG Cassette Series

Designed for low- and mid-rise applications, the Cassette system is designed to be used with most variations of 400 Series Curtainwall – CW, T, SS & TU framing for SSG exterior face of 1" glass thickness. This system has no exterior exposed metal, and adapts to an interior sight line of 2-1/2" using the strength of variable-depth backmembers. Tubelite's unique glass-to-edge design allows an all glass exterior appearance. Pivot and slide anchor system allows ease of installation.

A patent is pending on a number of features on this system.

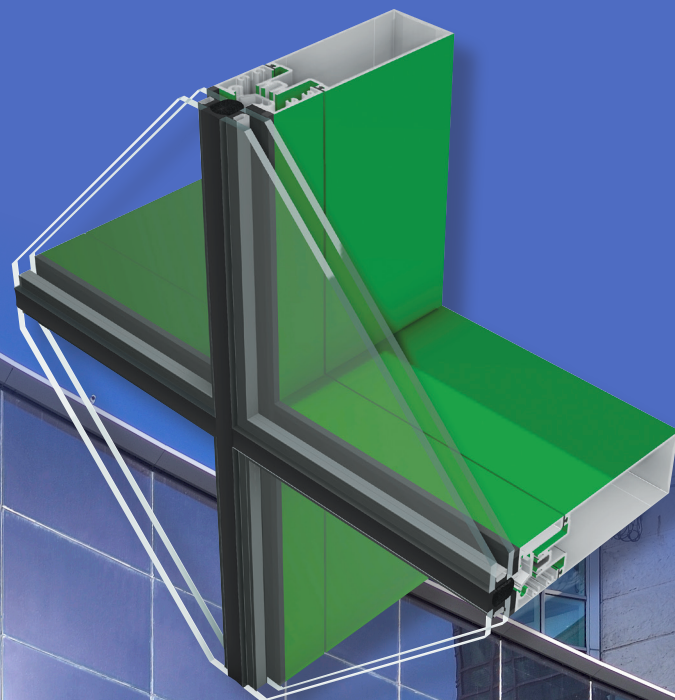

400 Series  
Curtainwall

ALSO  
USED  
WITH

MaxBlock®  
Sunshades by  
Tubelite®



**TUBELITE**®  
DEPENDABLE

LEADERS IN ECO-EFFICIENT STOREFRONT,  
CURTAINWALL AND ENTRANCE SYSTEMS

# 400 4-Side SSG Cassette Series

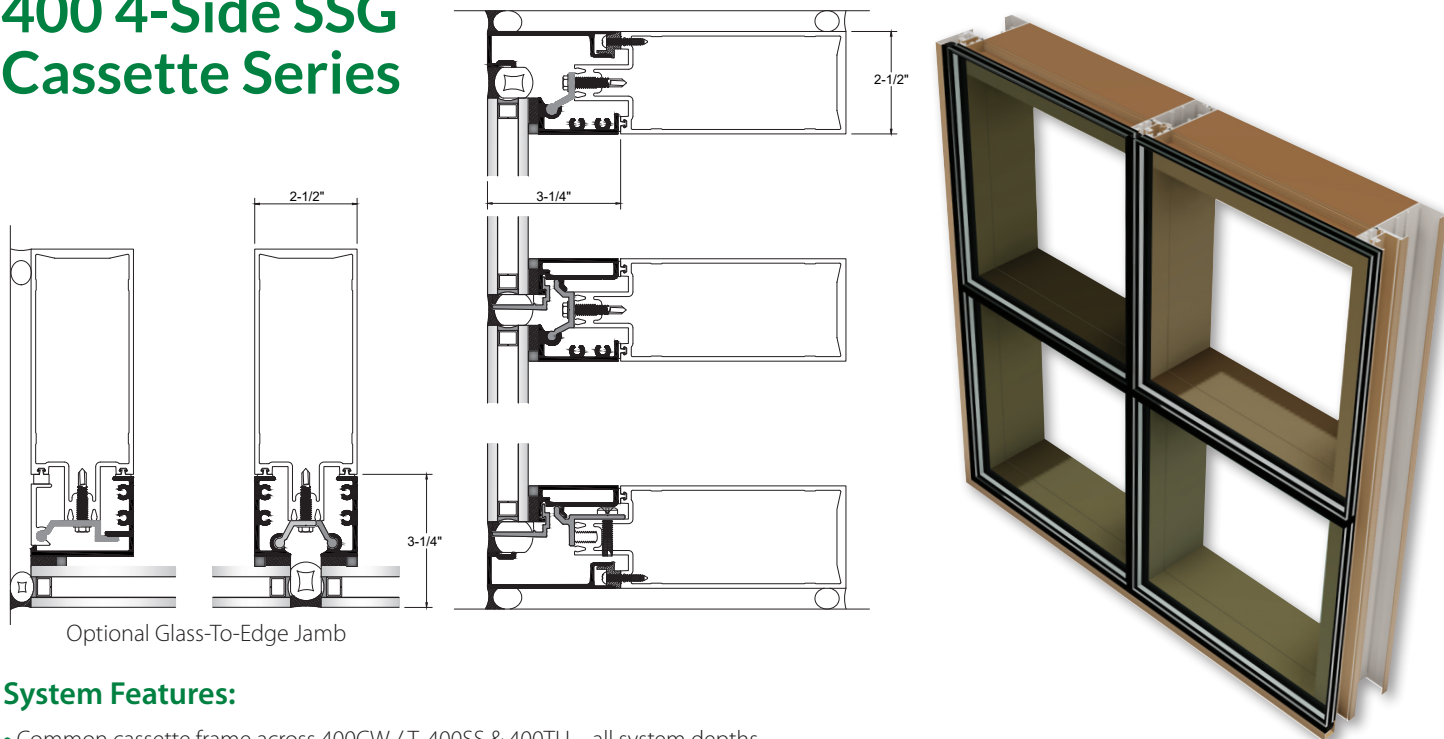

Optional Glass-To-Edge Jamb

## System Features:

- Common cassette frame across 400CW / T, 400SS & 400TU – all system depths
- “Pivot and slide” head and jamb anchors
- “Roll-over” dead load sill anchor
- “Glass-to-Edge” feature at perimeters
- Optional snap-on perimeter closure
- Door frame compatible
- Cassette SSG to traditional captured curtainwall transition
- Structural silicone glazing or 3M VHB tape glazing
- Outside and inside 90 degree corners
- Screw spline cassette frame construction
- Sun shade attachments
- Recessed alignment gasket
- Glass thickness – 1/4" to 1-5/16"
- Designed to attach to 2-1/2" face width back members
- Horizontal and Vertical accent covers can be added
- Anchors can be designed to allow renovation of existing buildings with curtainwall framing



Intermediate Vertical

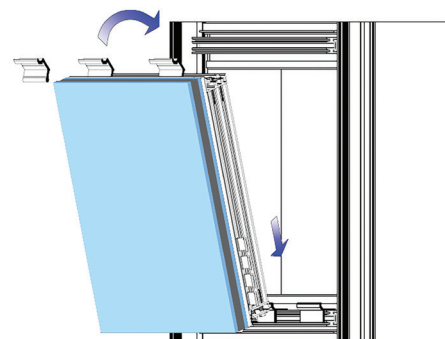

Cassette Frame Installation

## 400 4-Side SSG Cassette Series Product Specifications

**Application:** Low and mid-rise Commercial buildings including retail, office, healthcare, schools, etc.

**Description:** 2-1/2" x (5-5/8" to 10") shop glazed, screw spline construction cassette framing

Interior Face Width:	System Depth:	Glass:	Air Infiltration:	Water Infiltration:	Structural:	U-Factor**:	CRF (Frame):	Acoustic:
2-1/2"	up to 11-1/4"	1" std (1/4" – 1-5/16")	0.06 CFM/Ft.2 @ 6.24 PSF	15 PSF – Static 15 PSF – Dynamic	40 PSF – Design 60 PSF – Overload	0.32 - 400CW-SSG 0.31 - 400SS-SSG	400 CW/T - 85 400 SS - 84	32 STC 26 OITC

\*\* U-Factor per NFRC 100: COG = 0.24 with warm edge spacer, 1-3/4" x 4-1/2" non-thermal frame.

Refer to the U-Factor table at: [www.tubeliteinc.com/products/curtainwall/400-cassette/](http://www.tubeliteinc.com/products/curtainwall/400-cassette/) for other glass makeups and configurations.

DISCLAIMER: Tubelite takes no responsibility for product selection or application, including, but not limited to, compliance with building codes, safety codes, laws, merchantability or fitness for a particular purpose; and further disclaims all liability for the use, in whole or in part, of this Technical Guide in preparation of project specifications and/or other documents. Technical Guides are subject to change at any time, without notice, and at Tubelite's sole discretion. ©2018 Tubelite Inc.

092420

# TUBELITE®

**DEPENDABLE**

LEADERS IN ECO-EFFICIENT STOREFRONT,  
CURTAINWALL AND ENTRANCE SYSTEMS

# 400 SERIES CASSETTE

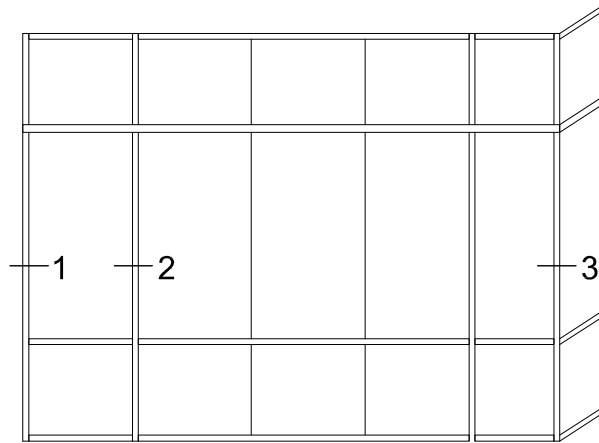

Tubelite reserves the right to change system configuration without prior notice when deemed necessary for product improvements.

Laws and building & safety codes governing the design and use of glazed entrance, window and curtain wall systems vary widely. Tubelite does not control the selection of product configurations, operating hardware or glazing materials, and assumes no responsibility thereof.

## 400 CASSETTE on 400SS

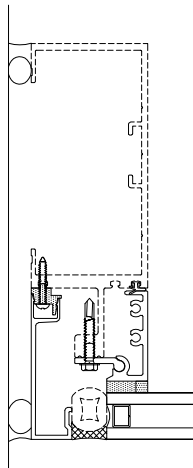

1

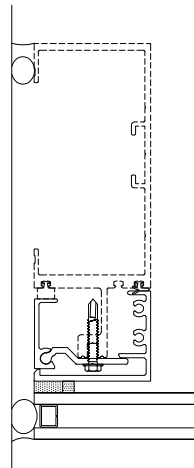

1A

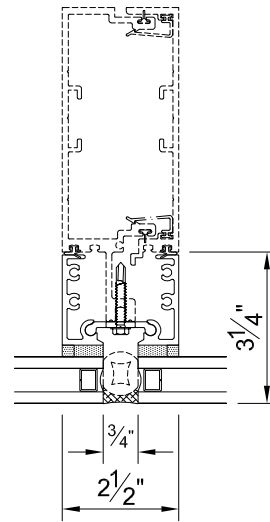

2

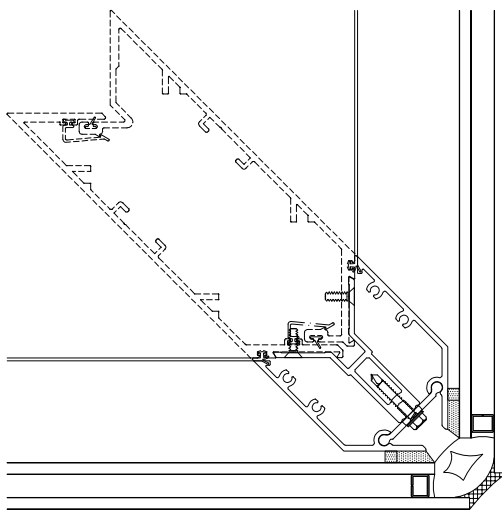

3

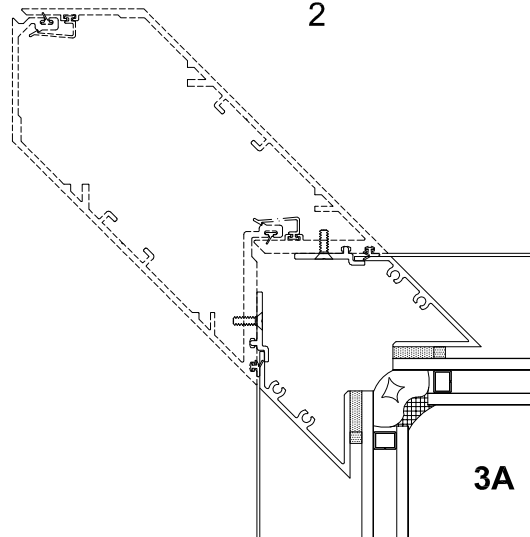

3A

**TUBELITE®**  
 DEPENDABLE  
 LEADERS IN ECO-EFFICIENT STOREFRONT,  
 CURTAINWALL AND ENTRANCE SYSTEMS

February 2020

For specific product applications, contact your Tubelite representative.  
 Details on this page represent standard details found on our website.  
 For more options, visit our website at [www.tubeliteinc.com/400-cassette](http://www.tubeliteinc.com/400-cassette)

# 400 SERIES CASSETTE

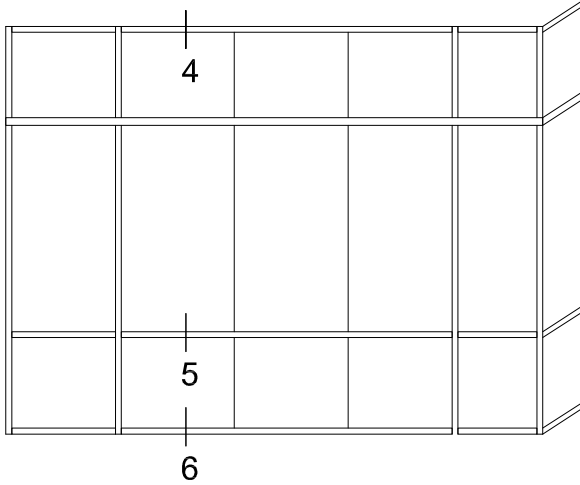

Tubelite reserves the right to change system configuration without prior notice when deemed necessary for product improvements.

Laws and building & safety codes governing the design and use of glazed entrance, window and curtain wall systems vary widely. Tubelite does not control the selection of product configurations, operating hardware or glazing materials, and assumes no responsibility thereof.

## 400 CASSETTE on 400SS

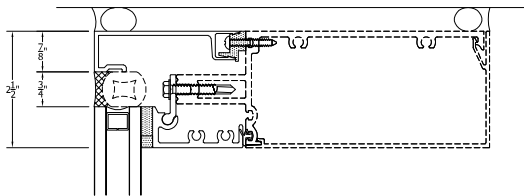

4

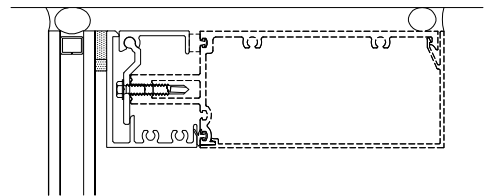

4A

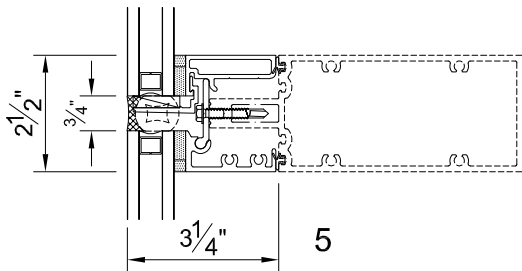

5

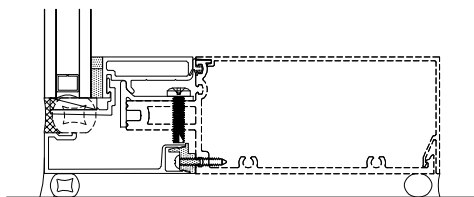

6

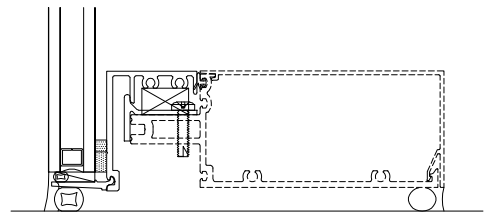

6A

**TUBELITE®**  
 DEPENDABLE  
 LEADERS IN ECO-EFFICIENT STOREFRONT,  
 CURTAINWALL AND ENTRANCE SYSTEMS

February 2020

For specific product applications, contact your Tubelite representative.  
 Details on this page represent standard details found on our website.  
 For more options, visit our website at [www.tubeliteinc.com/400-cassette](http://www.tubeliteinc.com/400-cassette)

# 400 SERIES CASSETTE

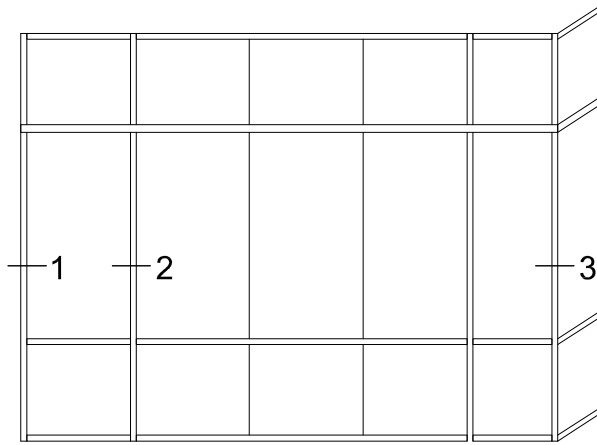

Tubelite reserves the right to change system configuration without prior notice when deemed necessary for product improvements.

Laws and building & safety codes governing the design and use of glazed entrance, window and curtain wall systems vary widely. Tubelite does not control the selection of product configurations, operating hardware or glazing materials, and assumes no responsibility thereof.

## 400 CASSETTE on 400T

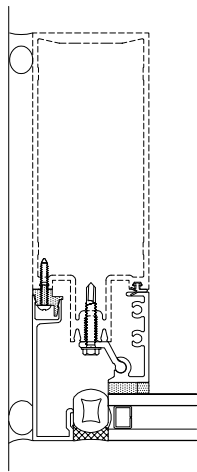

1

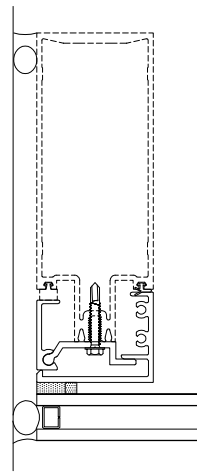

1A

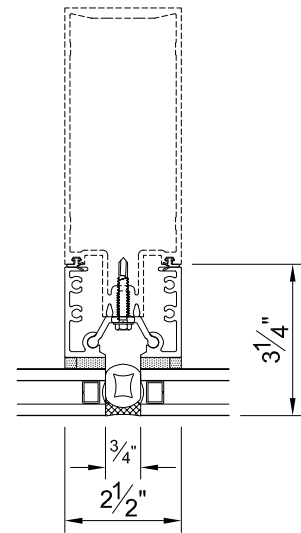

2

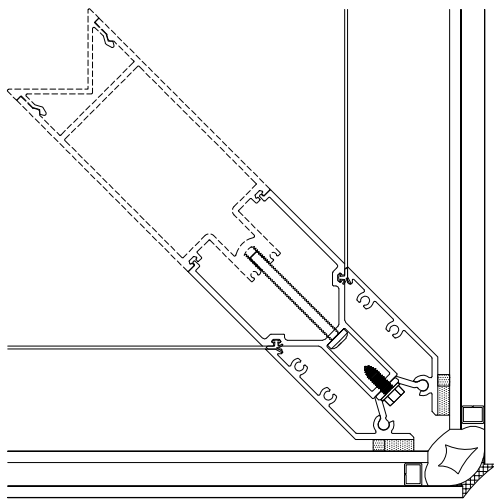

3

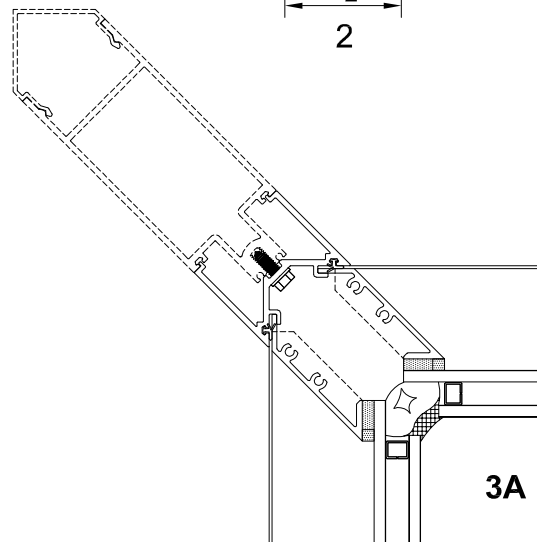

3A

**TUBELITE®**  
 DEPENDABLE  
 LEADERS IN ECO-EFFICIENT STOREFRONT,  
 CURTAINWALL AND ENTRANCE SYSTEMS

February 2020

For specific product applications, contact your Tubelite representative.  
 Details on this page represent standard details found on our website.  
 For more options, visit our website at [www.tubeliteinc.com/400-cassette](http://www.tubeliteinc.com/400-cassette)

# 400 SERIES CASSETTE

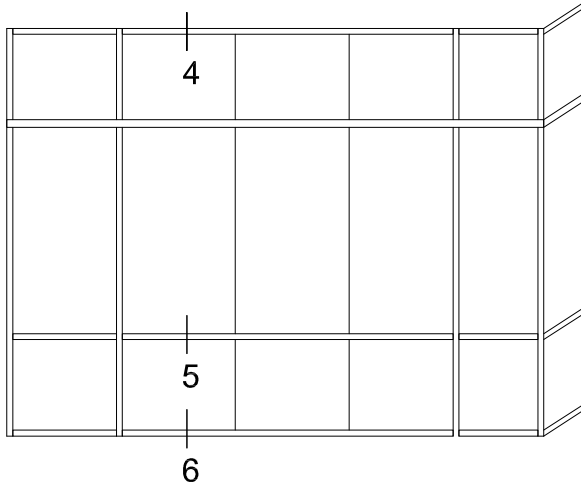

Tubelite reserves the right to change system configuration without prior notice when deemed necessary for product improvements.

Laws and building & safety codes governing the design and use of glazed entrance, window and curtain wall systems vary widely. Tubelite does not control the selection of product configurations, operating hardware or glazing materials, and assumes no responsibility thereof.

## 400 CASSETTE on 400T

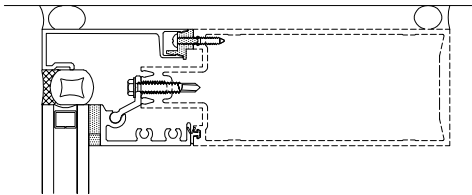

4

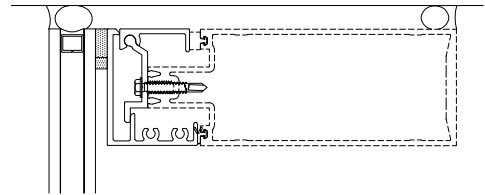

4A

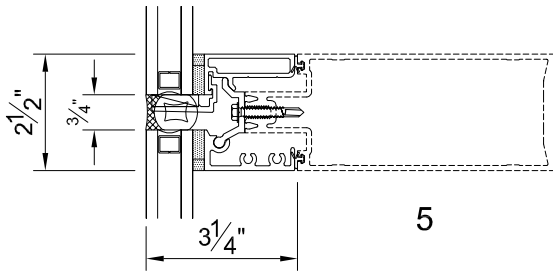

5

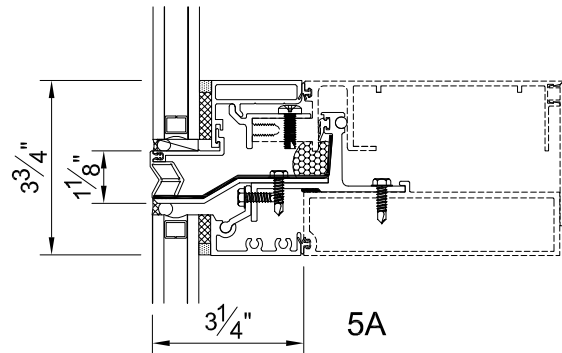

5A

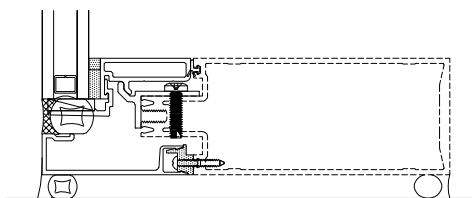

6

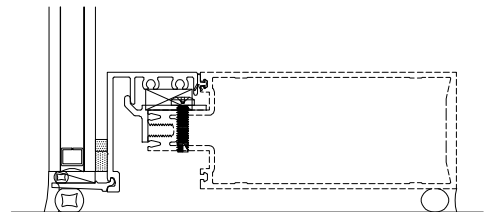

6A

**TUBELITE®**  
 DEPENDABLE  
 LEADERS IN ECO-EFFICIENT STOREFRONT,  
 CURTAINWALL AND ENTRANCE SYSTEMS

February 2020

For specific product applications, contact your Tubelite representative.  
 Details on this page represent standard details found on our website.  
 For more options, visit our website at [www.tubeliteinc.com/400-cassette](http://www.tubeliteinc.com/400-cassette)

400 SERIES CASSETTE

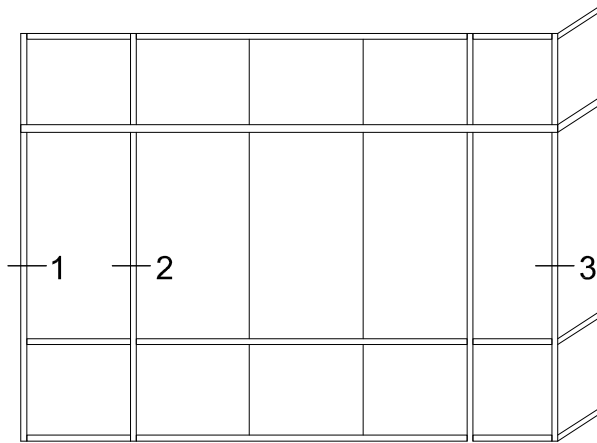

Tubelite reserves the right to change system configuration without prior notice when deemed necessary for product improvements.

Laws and building & safety codes governing the design and use of glazed entrance, window and curtain wall systems vary widely. Tubelite does not control the selection of product configurations, operating hardware or glazing materials, and assumes no responsibility thereof.

400 CASSETTE on 400TU

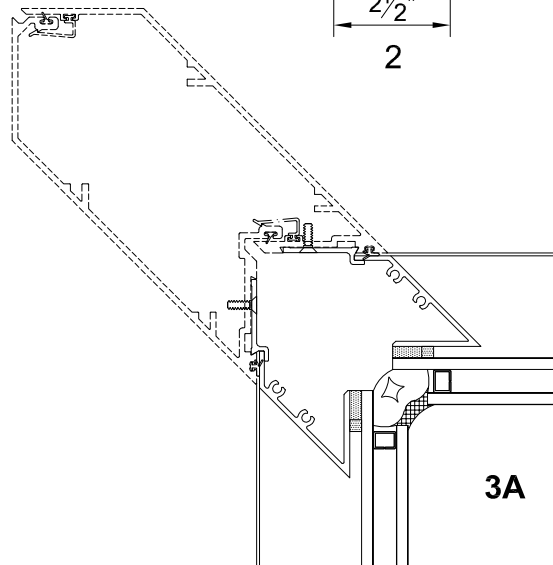
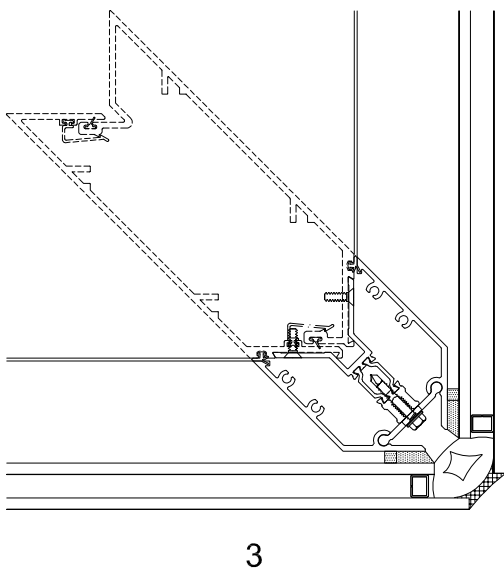
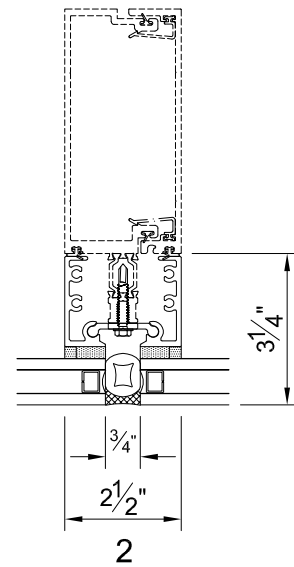
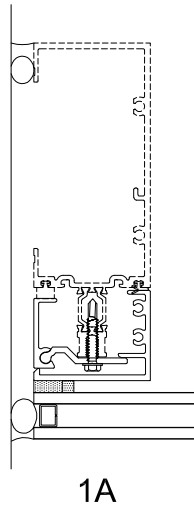
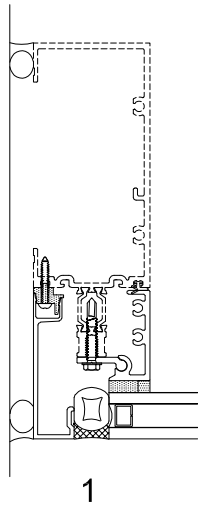

**TUBELITE**<sup>®</sup>  
 DEPENDABLE  
 LEADERS IN ECO-EFFICIENT STOREFRONT,  
 CURTAINWALL AND ENTRANCE SYSTEMS

February 2020

For specific product applications, contact your Tubelite representative.  
 Details on this page represent standard details found on our website.  
 For more options, visit our website at [www.tubeliteinc.com/400-cassette](http://www.tubeliteinc.com/400-cassette)

# 400 SERIES CASSETTE

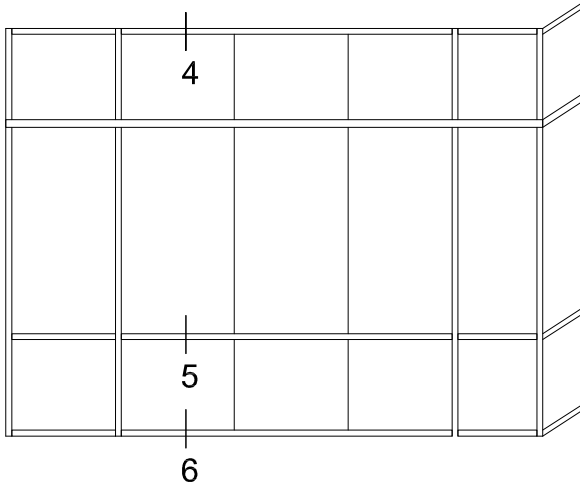

Tubelite reserves the right to change system configuration without prior notice when deemed necessary for product improvements.

Laws and building & safety codes governing the design and use of glazed entrance, window and curtain wall systems vary widely. Tubelite does not control the selection of product configurations, operating hardware or glazing materials, and assumes no responsibility thereof.

## 400 CASSETTE on 400TU

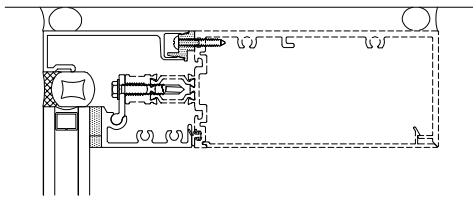

4

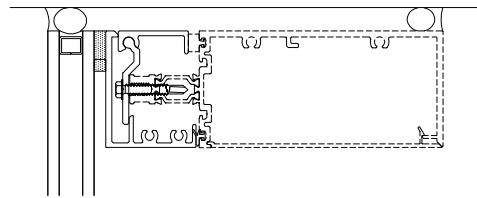

4A

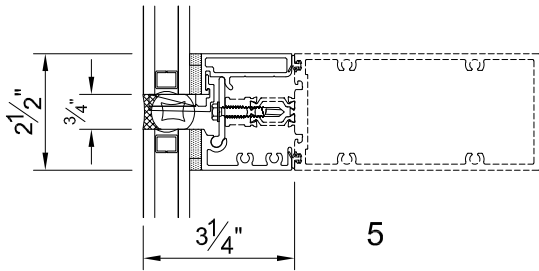

5

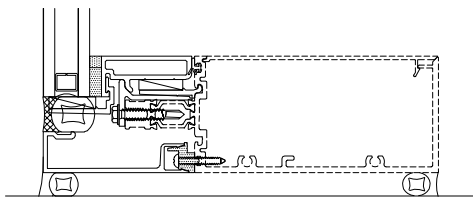

6

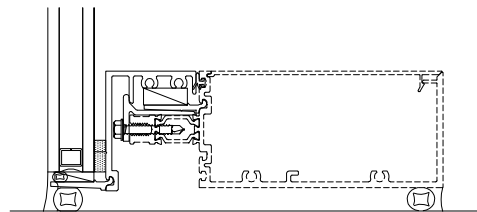

6A

**TUBELITE**<sup>®</sup>  
 DEPENDABLE  
 LEADERS IN ECO-EFFICIENT STOREFRONT,  
 CURTAINWALL AND ENTRANCE SYSTEMS

February 2020

For specific product applications, contact your Tubelite representative.  
 Details on this page represent standard details found on our website.  
 For more options, visit our website at [www.tubeliteinc.com/400-cassette](http://www.tubeliteinc.com/400-cassette)