

**6SD.01**  
**E34000 Series ForceFront Storm Storefront**  
Non Thermal - Wet Seal  
Description

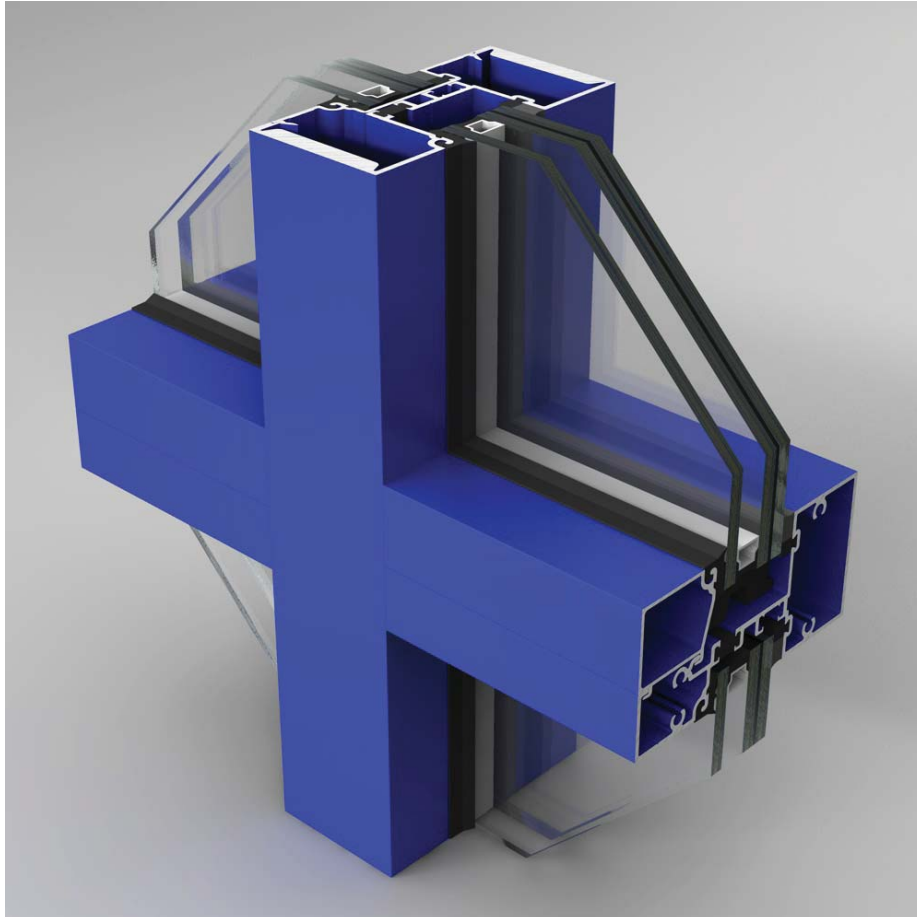

**Description**

Tubelite E34000 Series Framing is a 2 1/2" x 5" flush glazed storefront system for use on first floor applications. This impact resistant screw-spline framing can be glazed with 1 5/16" laminated insulated glass positioned in the center of the frame. It has been tested for large missile impact, and

passed at Level D. Static and Cyclic Load Tests were performed at +70/-68 psf. This system is wet glazed at the interior side and internally drained.

# 6SD.02

## E34000 Series ForceFront Storm Storefront

### Non Thermal - Wet Seal

### Guide Specifications

#### General

##### Description

Furnish all necessary materials, labor and equipment for the complete installation of aluminum framing as shown on the drawings and specified herein.

Fixed window framing shall be E34000 Series (2 1/2" x 5") as manufactured by Tubelite Inc., Walker, Michigan. Whenever substitute products are to be considered, supporting technical literature, samples drawings and performance data must be submitted ten (10) days prior to bid in order to make a valid comparison of the products involved.

Test reports certified by an independent laboratory must be made available upon request.

##### Performance Requirements

Air infiltration shall not exceed .06 CFM/Ft<sup>2</sup> when tested in accordance with ASTM E-283 at a test pressure of 6.24 PSF.

There shall be no uncontrolled water entry when tested in accordance with ASTM E-331 "Water Penetration of Exterior Windows, Curtainwalls and Doors by Uniform Static Air Pressure Difference" at a test pressure of 15 PSF.

There shall be no uncontrolled water entry when tested in accordance with AAMA 501.1-94 at a dynamic pressure equivalent of 15 PSF.

Structural performance per ASTM E330 shall be based on a maximum allowable deflection of L/175 of the span or 3/4" maximum. The system shall perform to those criteria under a wind load of +70/-68 PSF.

There shall be no buckling, stress on glass, edge seal failure, excess stress on storefront structure, anchors and fasteners or reduction in performance when tested in accordance with AAMA 501.5-98 at a temperature range of 0° to 180° F.

The system shall have a Sound Transmission Class (STC) rating of 32 and an Outdoor-Indoor Transmission Class (OITC) rating of 31 when tested in accordance with ASTM E90-09, ASTM E413-10 and ASTM E1332-10a.

Large & Small Missile Impact - Level D, and Cyclic Load testing per ASTM E 1886/1996 and TAS 203 at a Design Pressure of +70/-68 PSF passed.

#### Products

##### Materials

Extrusions shall be of aluminum alloy 6063-T5 extruded within commercial tolerance and free from defects impairing strength and/or durability. Main framing sections to be of .075 inch minimum wall thickness and glazing stop moldings of .060 inch thickness.

Screws, bolts and all other accessories to be compatible with the aluminum under normal service conditions. Final fasteners and anchors must be reviewed and approved by a Professional Engineer.

Glazing shall be by means of an exterior roll-in wedge of high quality extruded elastomeric material, and an interior seal around the glass perimeter using DOW 995 structural silicone.

##### Finish

All exposed framing surfaces shall be free of scratches and other serious blemishes.

Finish to be: (architect select)

Etched and clear anodized

(AAM10C21A31)

Clear - Class II (C2)

(AAM10C21A41)

Clear - Class I (C1)

Electrolytically deposited color

(AAM10C21A44) Class 1

Champagne (CH)

Medium Bronze (MB)

Light Bronze (LB)

Dark Bronze (DB)

Extra Dk Bronze (EB)

Black (BL)

Copper (CA)

Fluoropolymer (70%) painted color \_\_\_\_\_.

#### Execution

##### Installation

Shall be in accordance with the manufacturer's installation instructions and the approved shop drawings.

##### Note:

In keeping with Tubelite's policy of continuing product improvements, all specifications are subject to change without written notice by the manufacturer.

# E34000 Series ForceFront Storm Storefront

Non Thermal - Wet Seal

Key Elevation & 1/8 Scale Details

CAD File Name: 515ELEV

TYPICAL  
ELEVATION

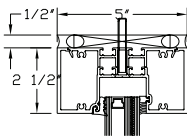
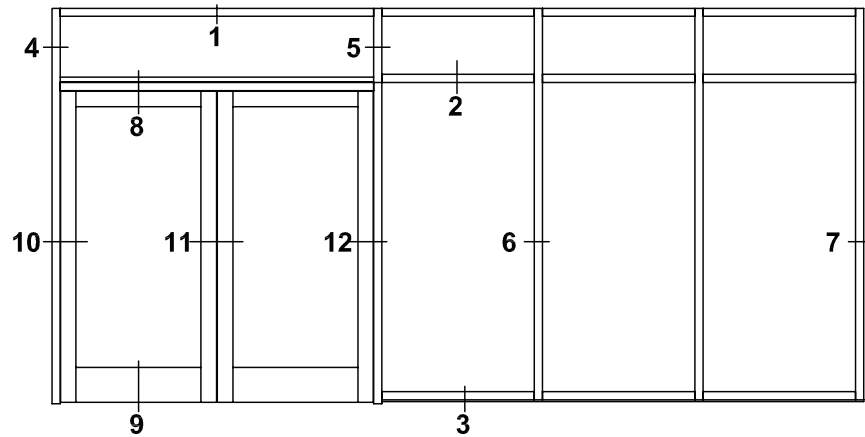

1

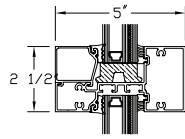

2

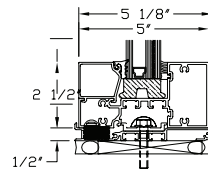

3

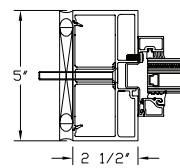

4

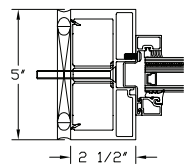

4a

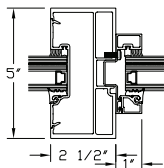

5

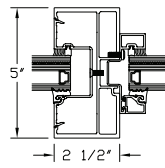

5a

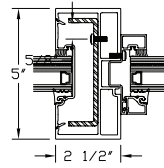

5b

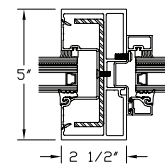

5c

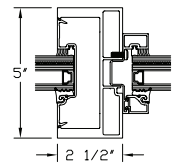

5d

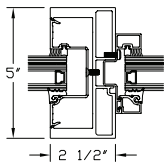

5e

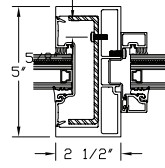

5f

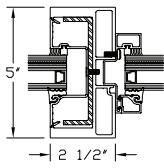

5g

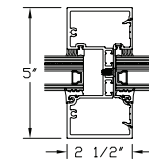

6

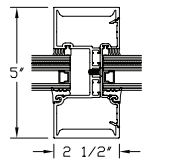

6a

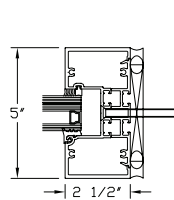

7

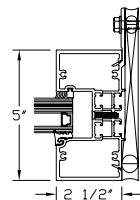

7a

\*SEALANT, ROD, & ANCHORS NOT BY TUBELITE

# 6SD.04

## E34000 Series ForceFront Storm Storefront

Non Thermal - Wet Seal

1/8 Scale Details

CAD File Name: 515ELEV2

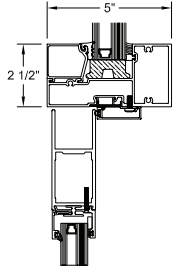

8

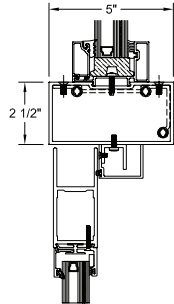

8a

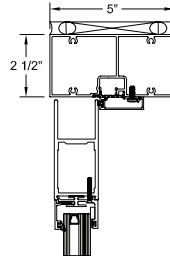

8b

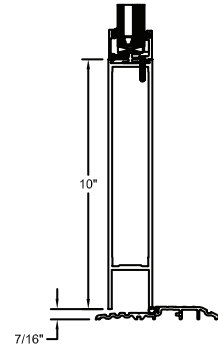

9

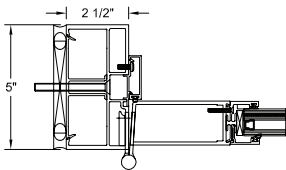

10

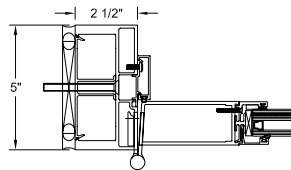

10a



11

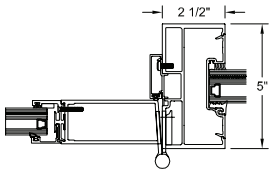

12

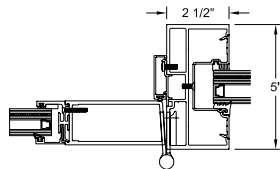

12a

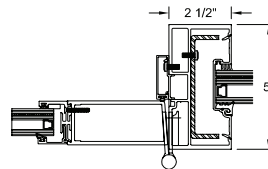

12b

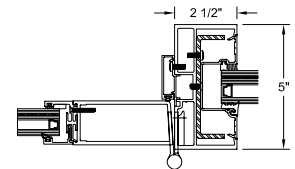

12c

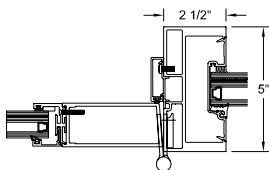

12d

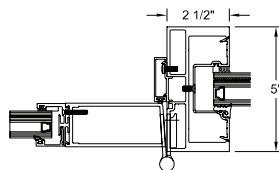

12e

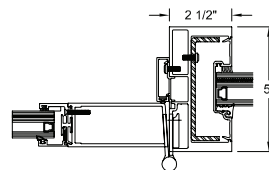

12f

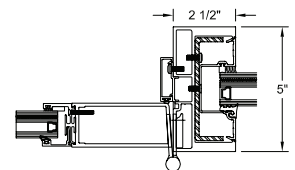

12g

**6SD.05**  
**E34000 Series ForceFront Storm Storefront**  
Non Thermal - Wet Seal  
Isometric Detail

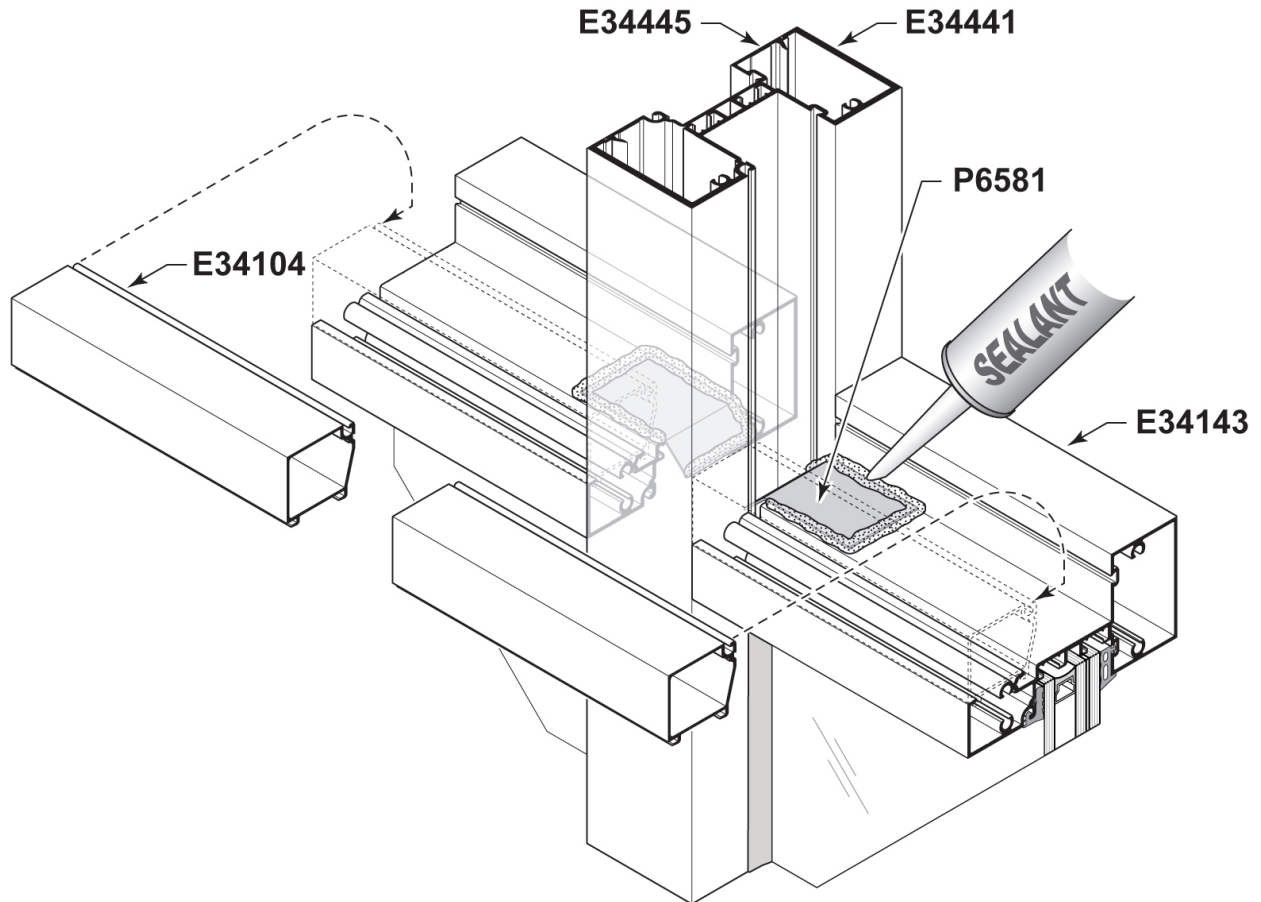

# 6SD.06 E34000 Series ForceFront Storm Storefront Non Thermal - Wet Seal Isometric Detail

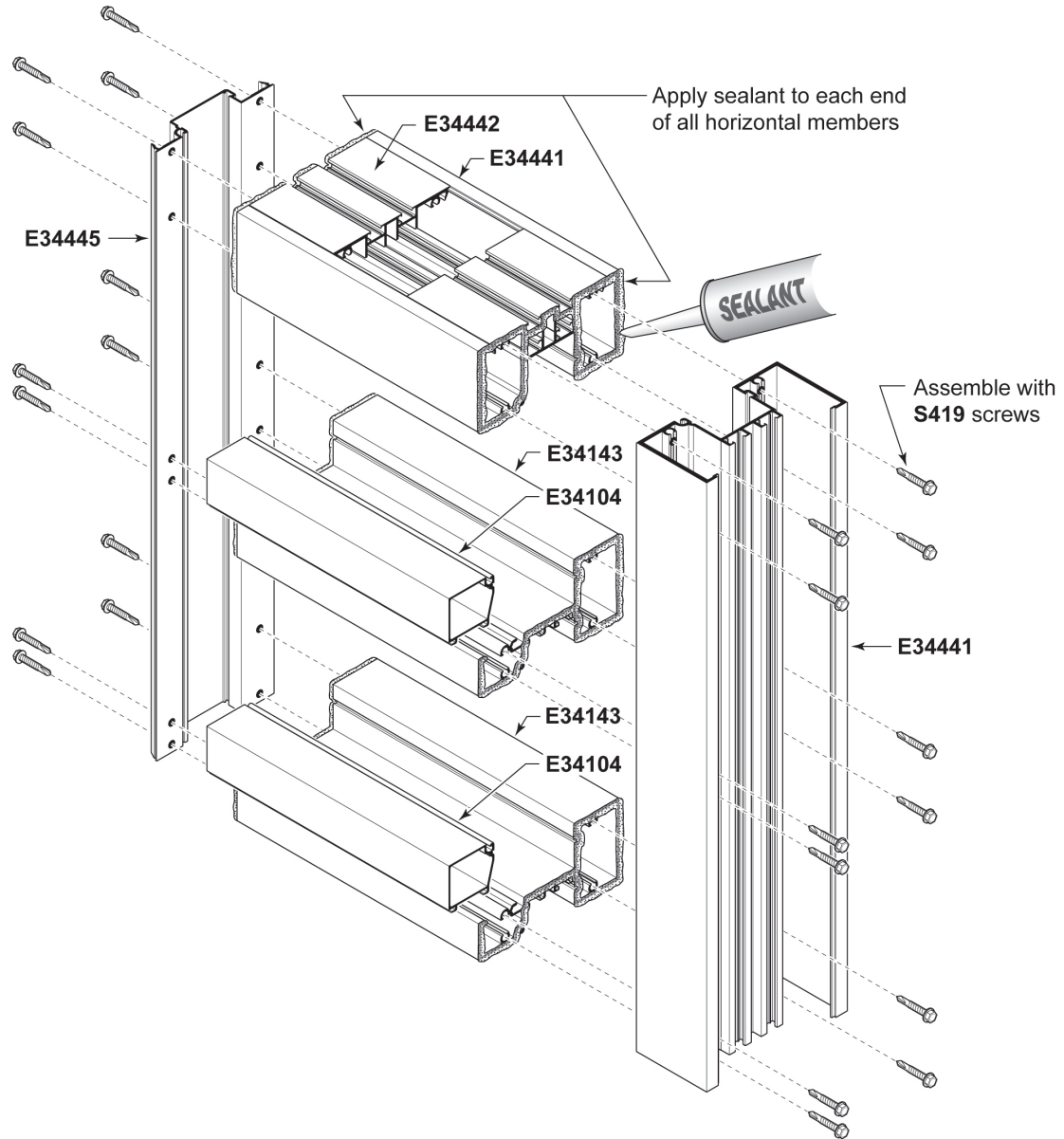

**6SD.07**  
**E34000 Series Hurricane Impact Storefront**  
**Wet Glaze, Non Thermal**  
**Sidelite Head**  
**CAD File: 515HEAD**

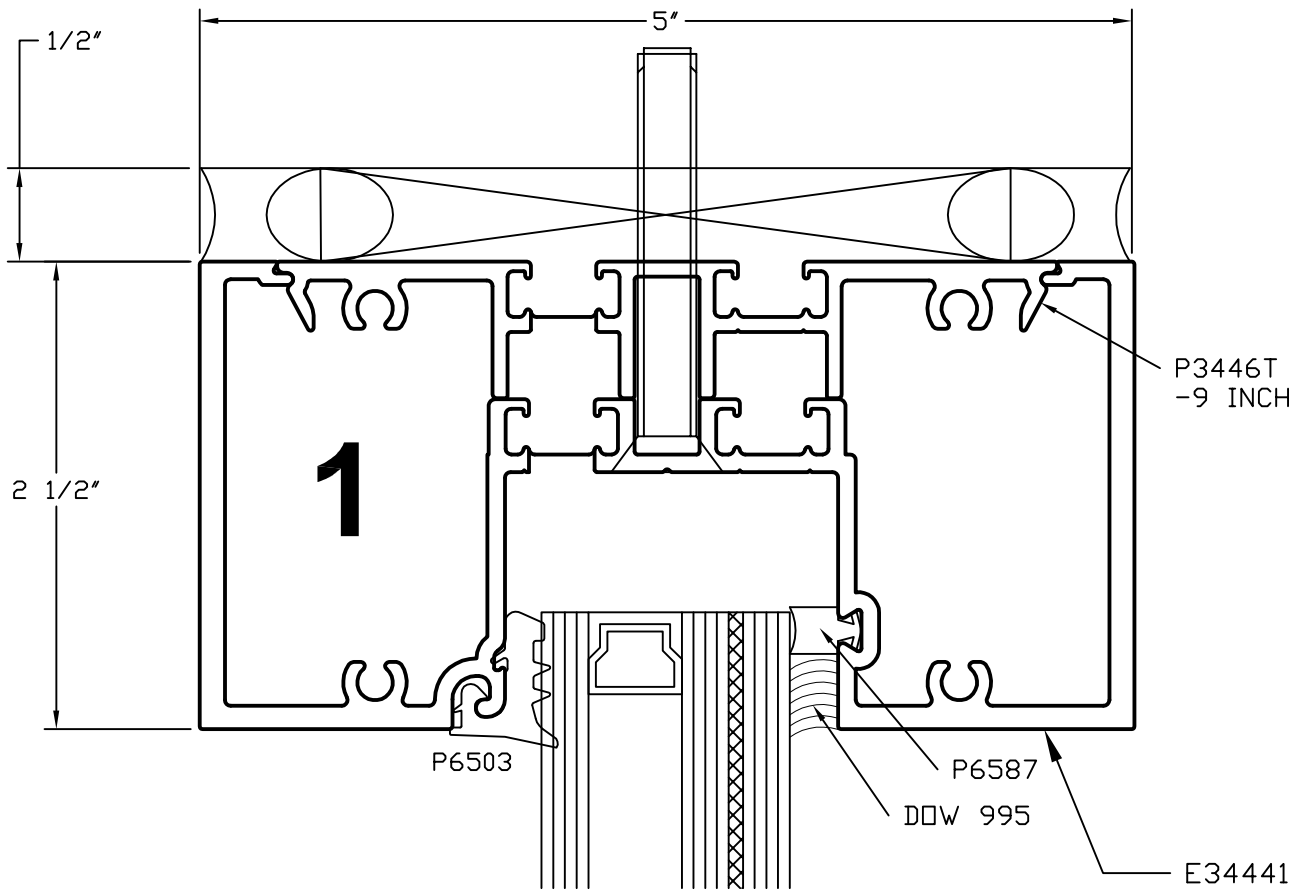

6SD.08

E34000 Series Hurricane Impact Storefront

Wet Glaze, Non Thermal

Sidelite Horizontal

CAD File: 515HORZ

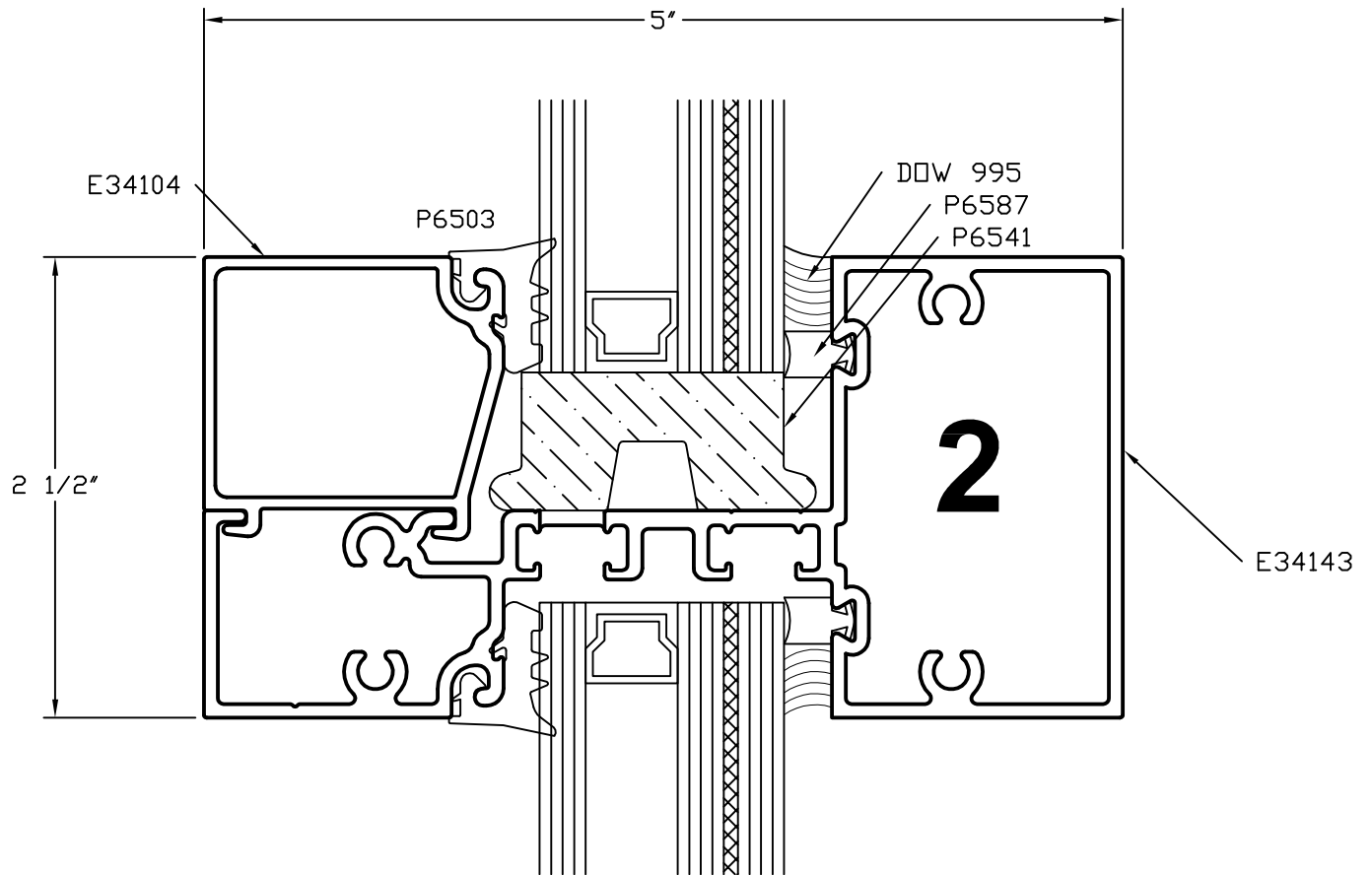

TUBELITE®

DEPENDABLE

LEADERS IN ECO-EFFICIENT STOREFRONT,  
CURTAINWALL AND ENTRANCE SYSTEMS

2014

\*SEALANT, ROD, & ANCHORS NOT BY TUBELITE



**6SD.09**  
**E34000 Series Hurricane Impact Storefront**  
**Wet Glaze, Non Thermal**  
**Sidelite Sill**  
**CAD File: 515SILL**

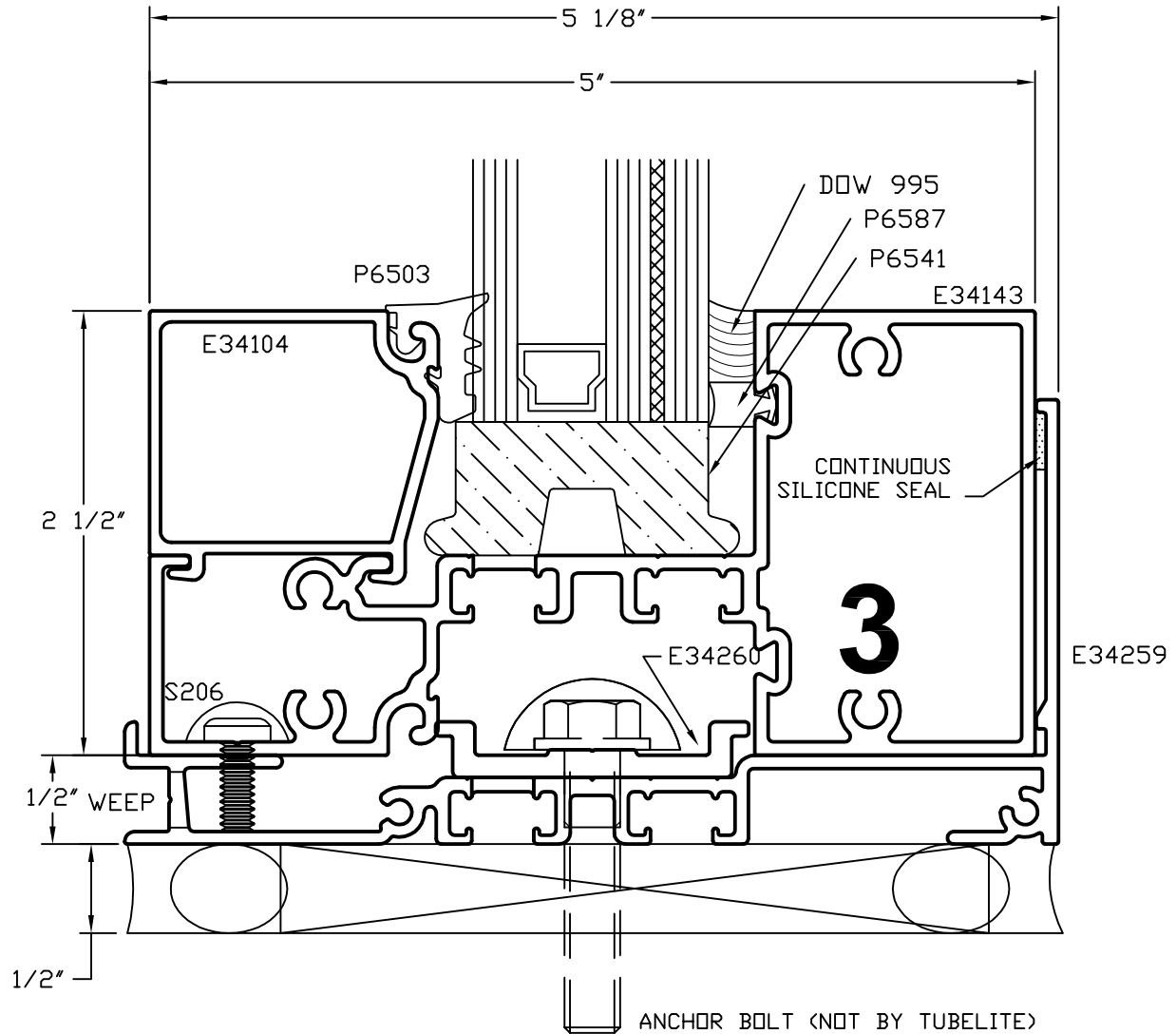

**6SD.10**  
**E34000 Series Hurricane Impact Storefront**  
**Wet Glaze, Non Thermal**  
**Sidelite Jamb**  
**CAD File: 515JAMB**

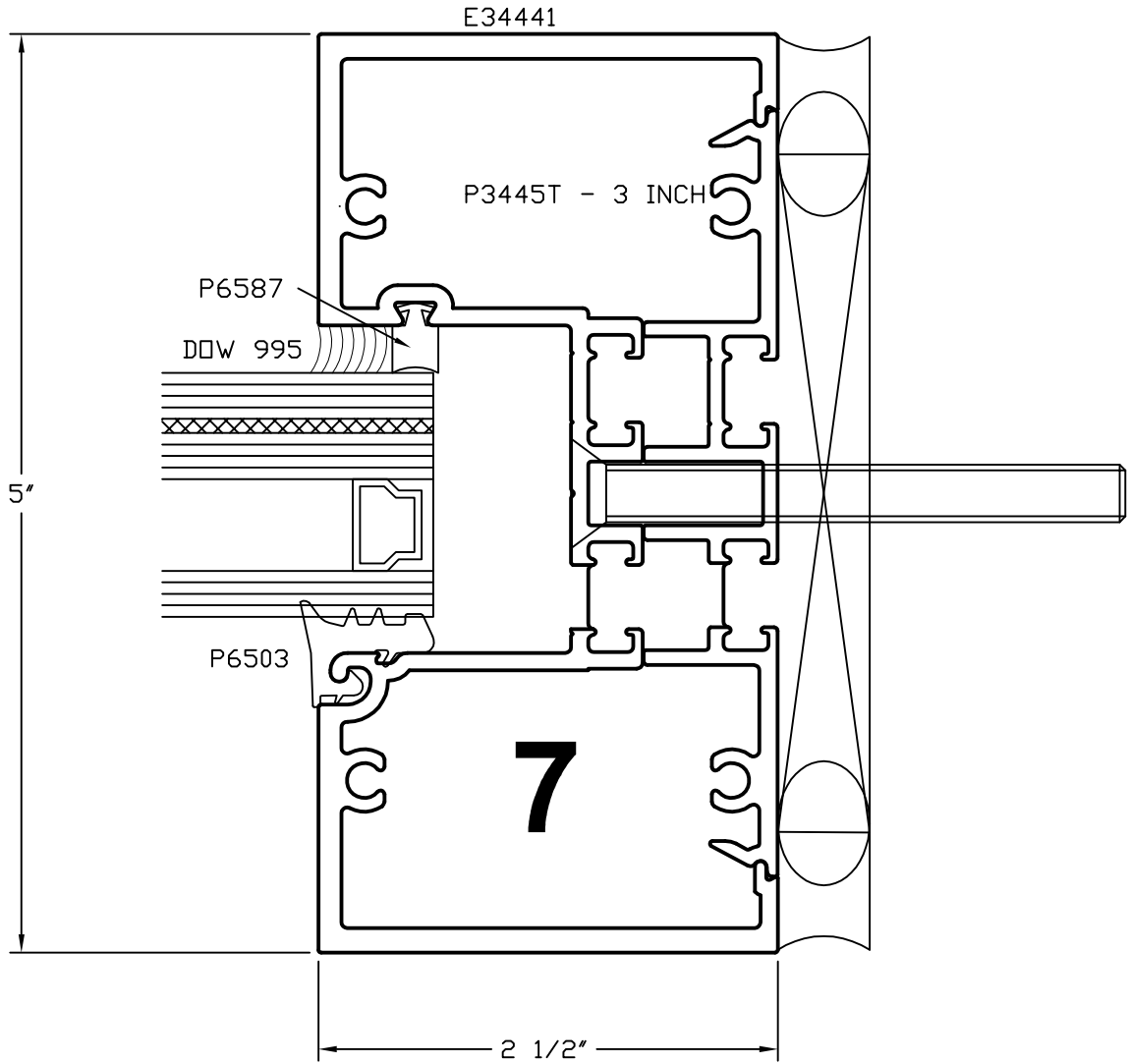

**6SD.11**  
**E34000 Series Hurricane Impact Storefront**  
**Wet Glaze, Non Thermal**  
**Sidelite Jamb - with Strap Anchor**  
**CAD File: 515JAMB1**

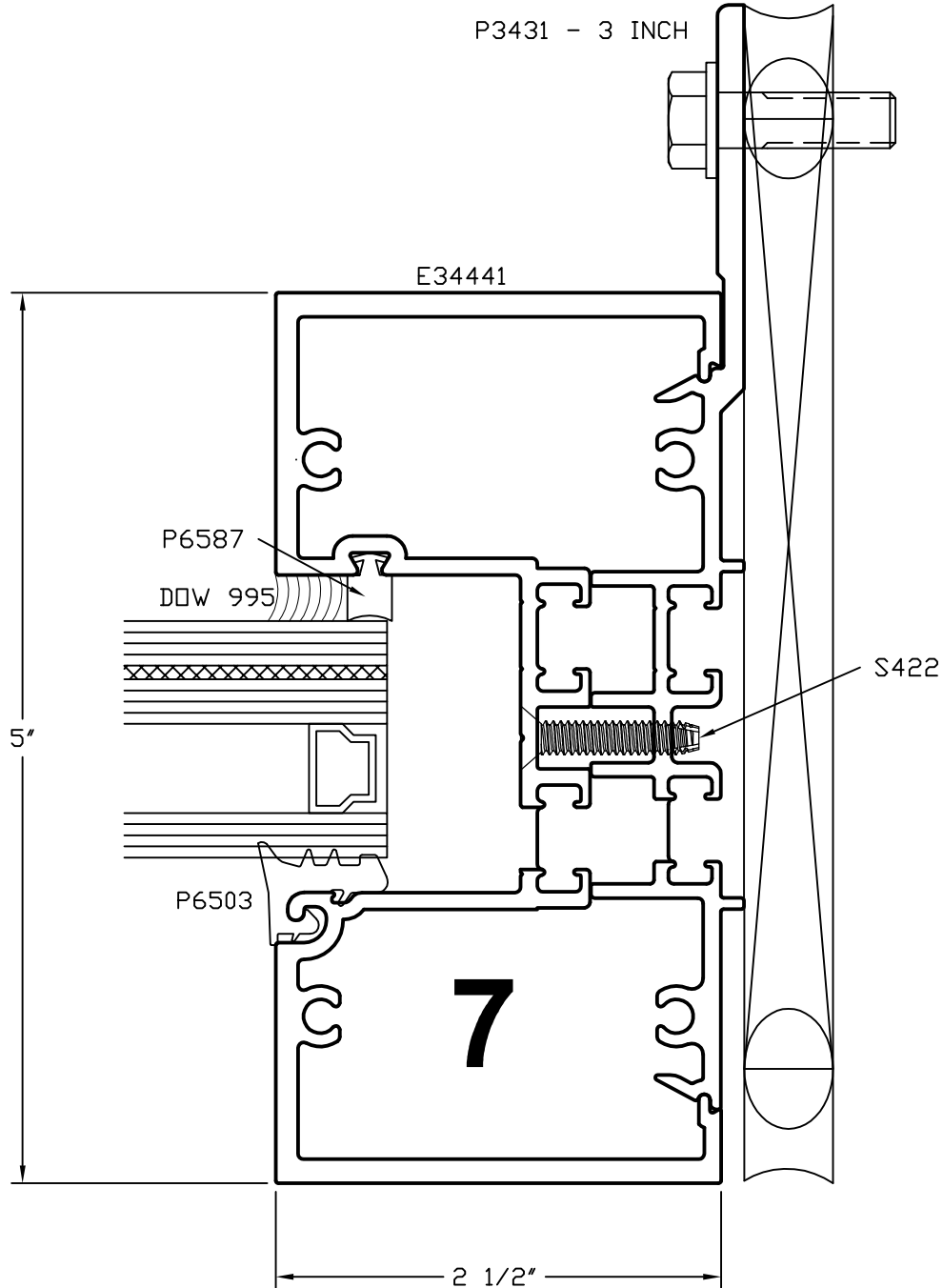

**6SD.12**  
**E34000 Series Hurricane Impact Storefront**  
**Wet Glaze, Non Thermal**  
Heavy Duty Intermediate Vertical  
CAD File: 515HVRT

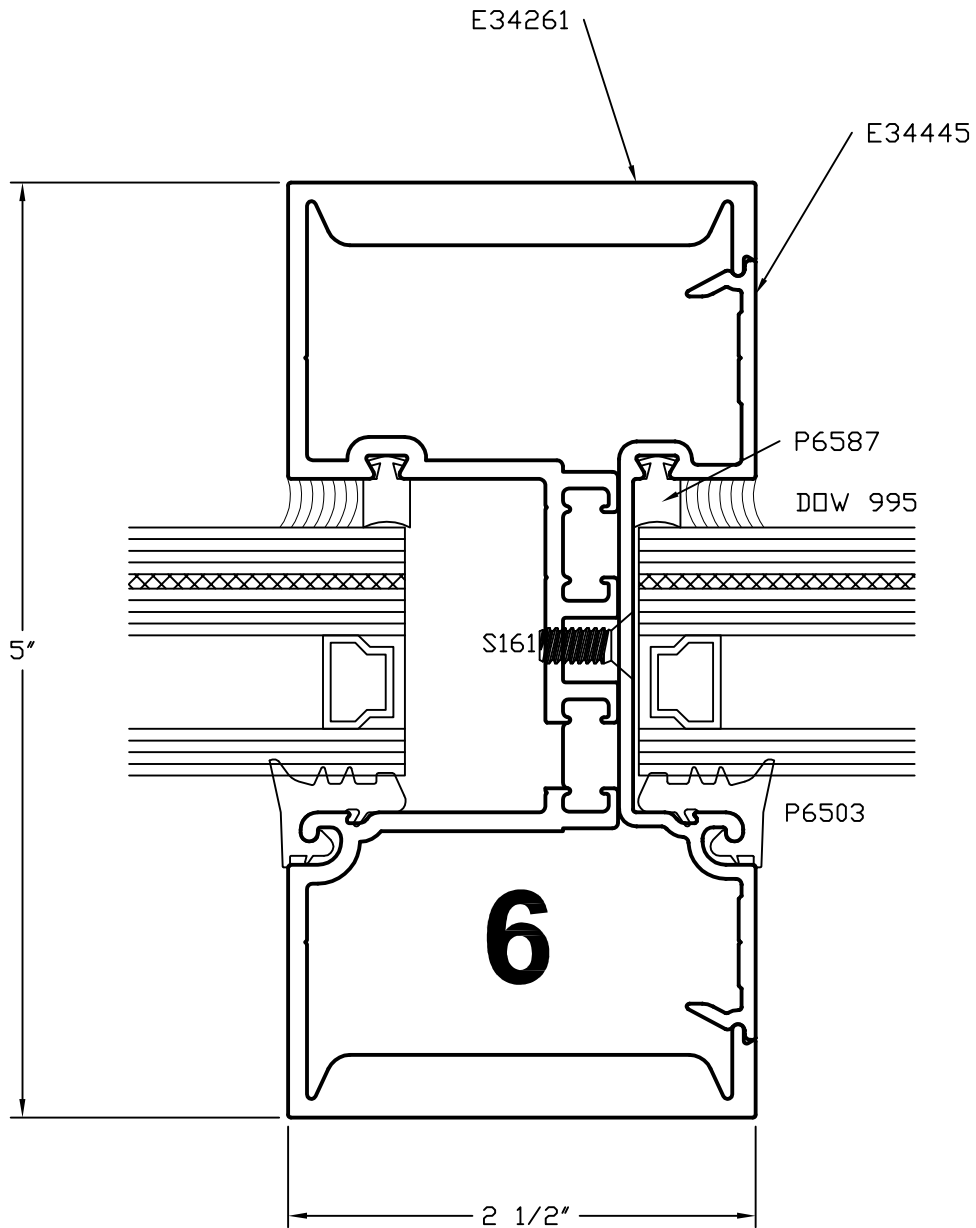

**6SD.13**  
**E34000 Series Hurricane Impact Storefront**  
**Wet Glaze, Non Thermal**  
**Intermediate Vertical - Shallow Pocket**  
**CAD File: 515VERT**

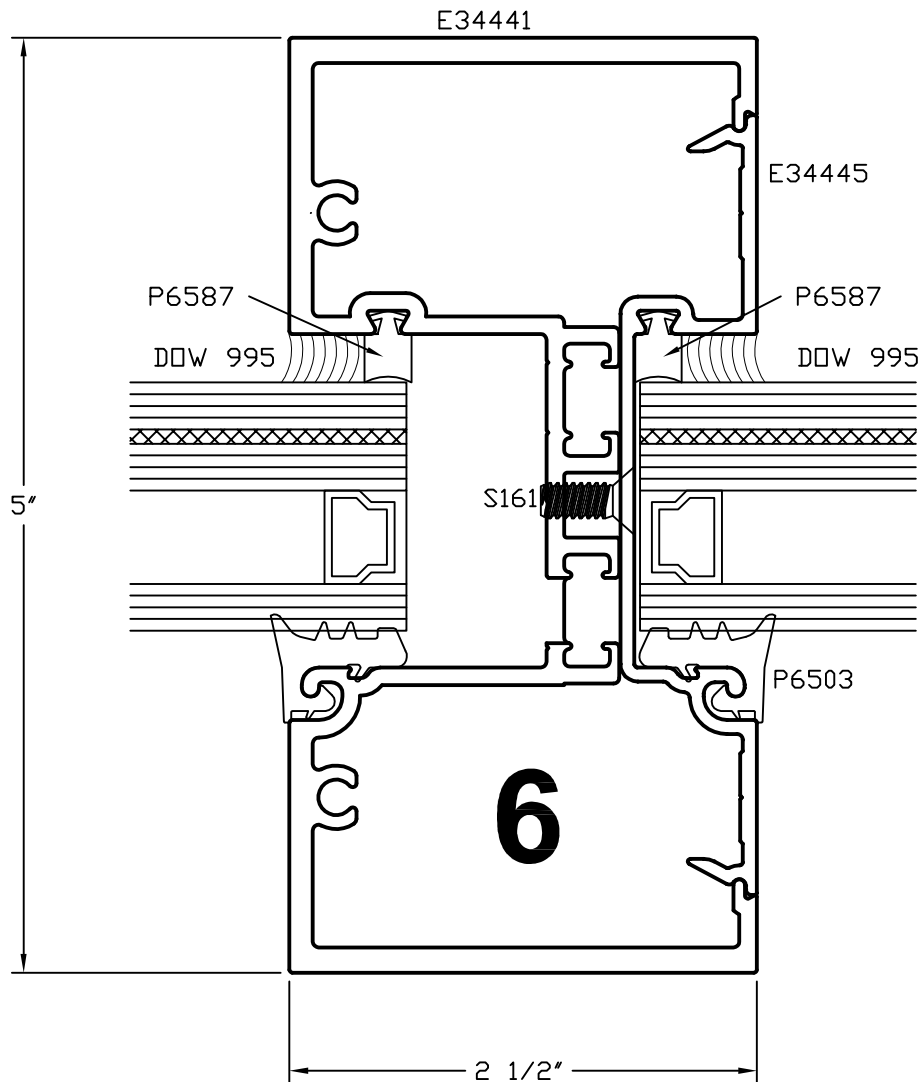

**6SD.14**  
**E34000 Series Hurricane Impact Storefront**  
**Wet Glaze, Non Thermal**  
 Door Header  
 CAD File: 515DRHD

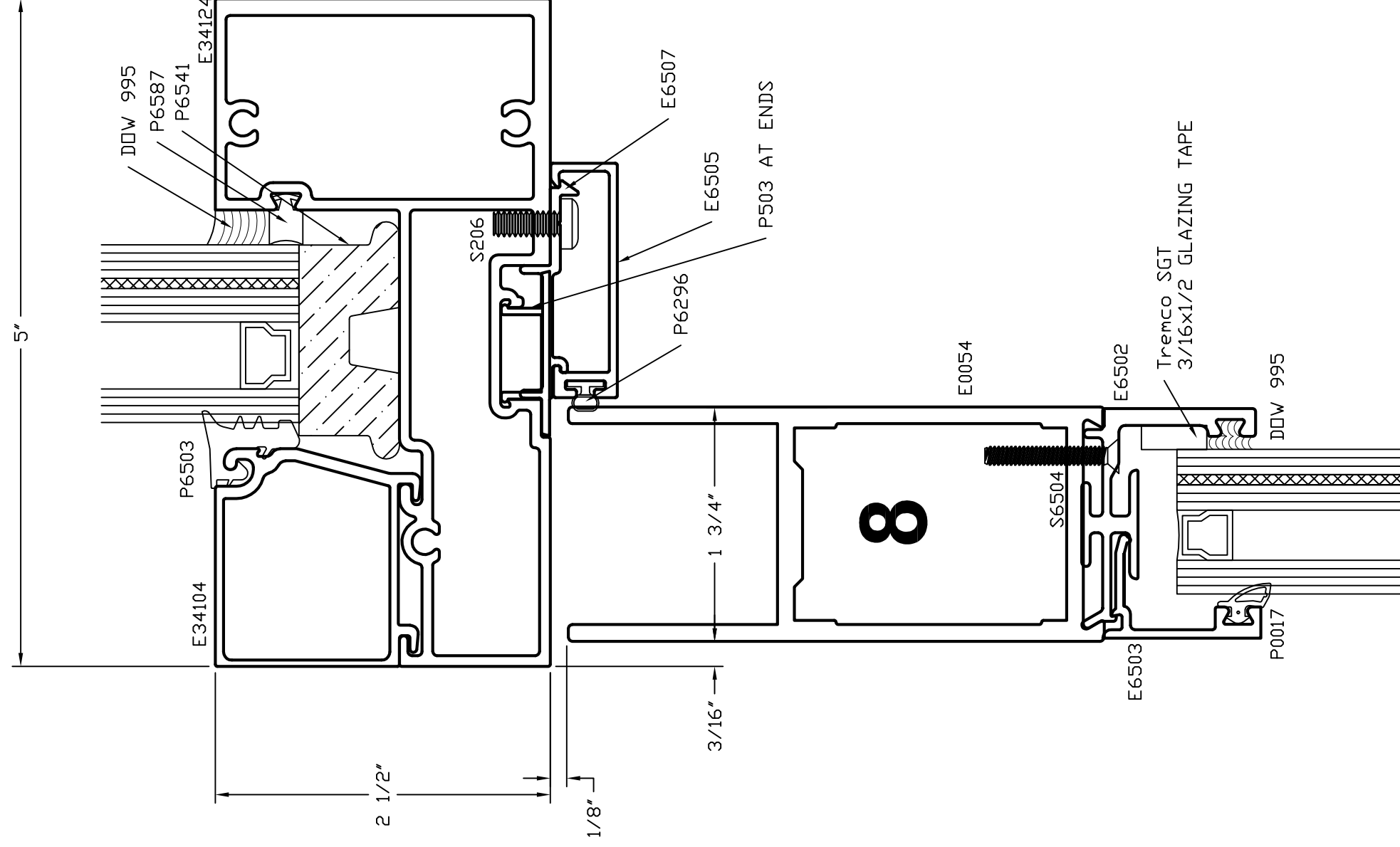

**6SD.15**  
**E34000 Series Hurricane Impact Storefront**  
**Wet Glaze, Non Thermal**  
 Door Header - with OHCC  
 CAD File: 515DRHD1

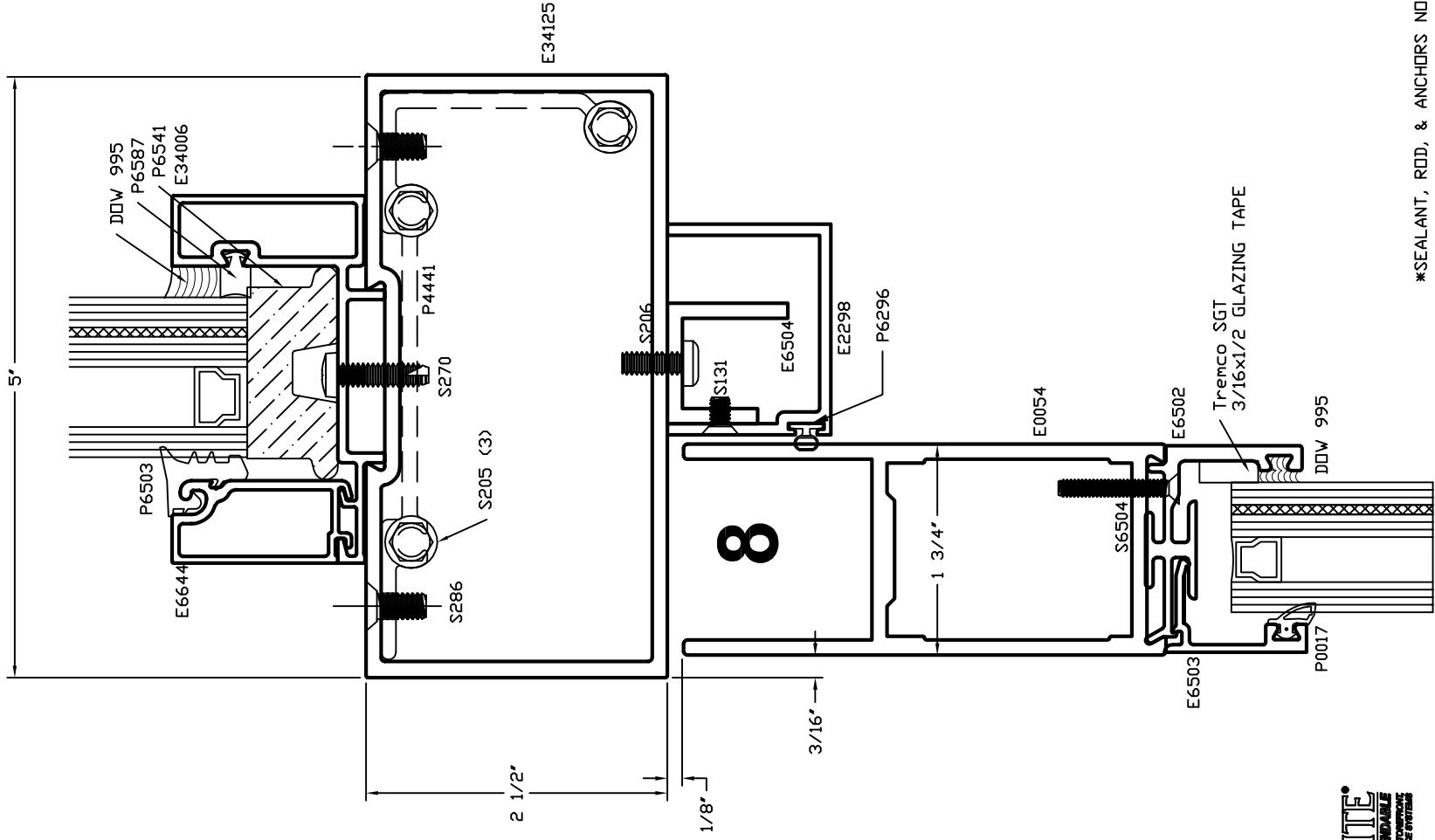

**6SD.16**  
**E34000 Series Hurricane Impact Storefront**  
**Wet Glaze, Non Thermal**  
 Door Header - without Transom  
 CAD File: 515DRHD2

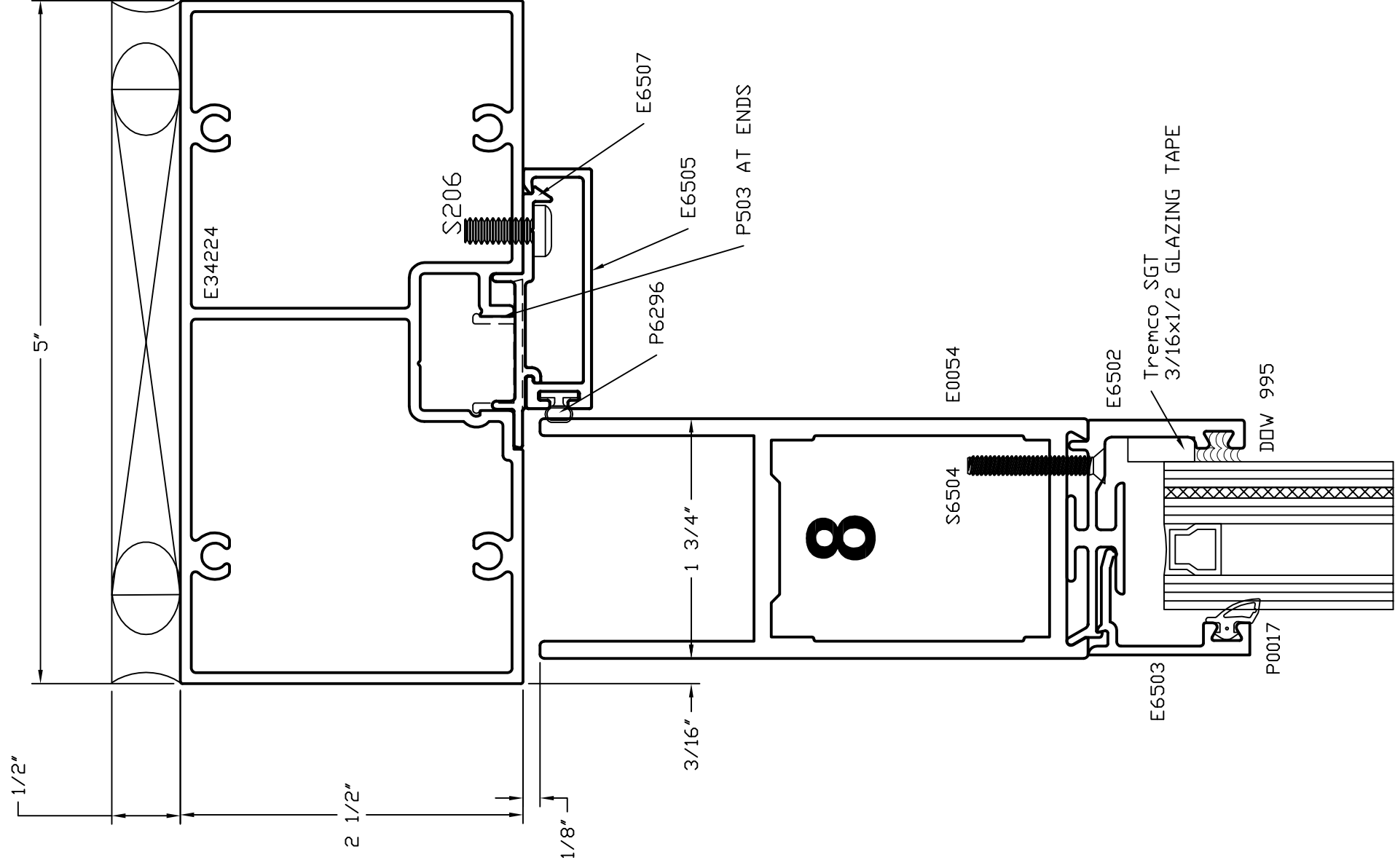



**6SD.17**  
**E34000 Series Hurricane Impact Storefront**  
**Wet Glaze, Non Thermal**  
**Bottom Rail and Threshold**  
**CAD File: 515DRBR**

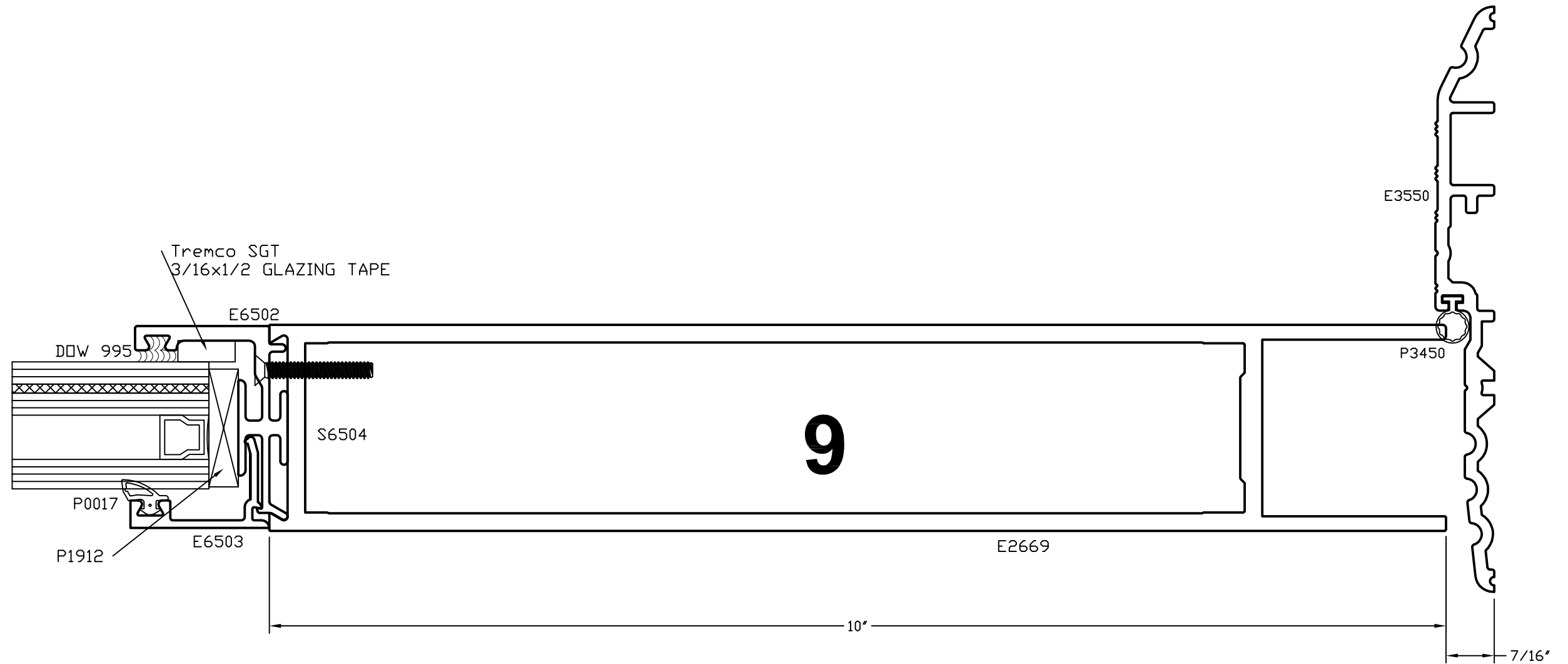



**6SD.19**  
**E34000 Series Hurricane Impact Storefront**  
**Wet Glaze, Non Thermal**  
**Transom Vertical**  
**CAD File: 515TRANVT**

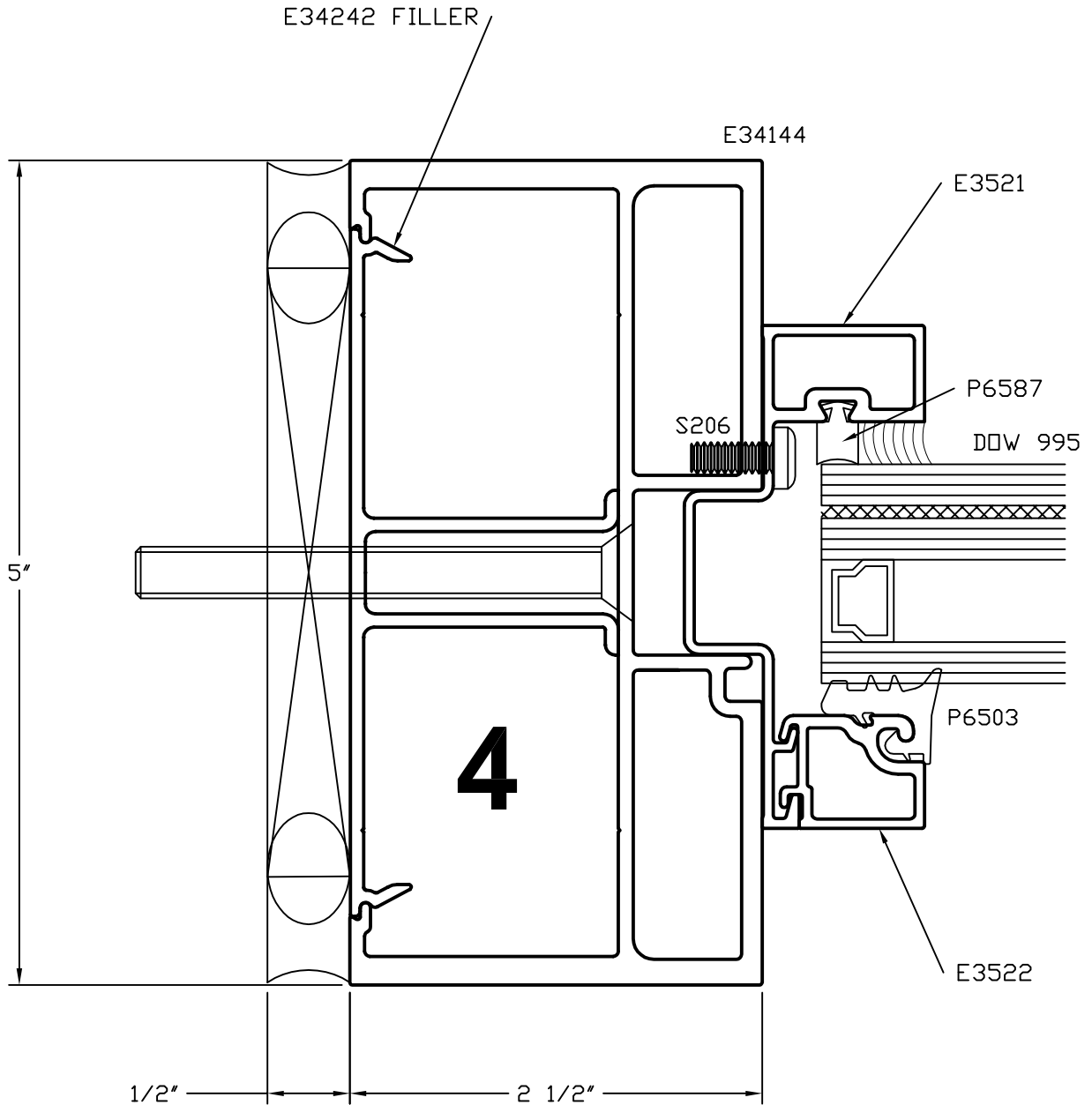

**TUBELITE**  
 DEPENDABLE  
 LEADERS IN ECO-EFFICIENT STOREFRONT,  
 CURTAINWALL AND ENTRANCE SYSTEMS

2014

\*SEALANT, ROD, & ANCHORS NOT BY TUBELITE

**6SD.20**  
**E34000 Series Hurricane Impact Storefront**  
**Wet Glaze, Non Thermal**  
**Transom Vertical**  
**CAD File: 515TRANVT1**

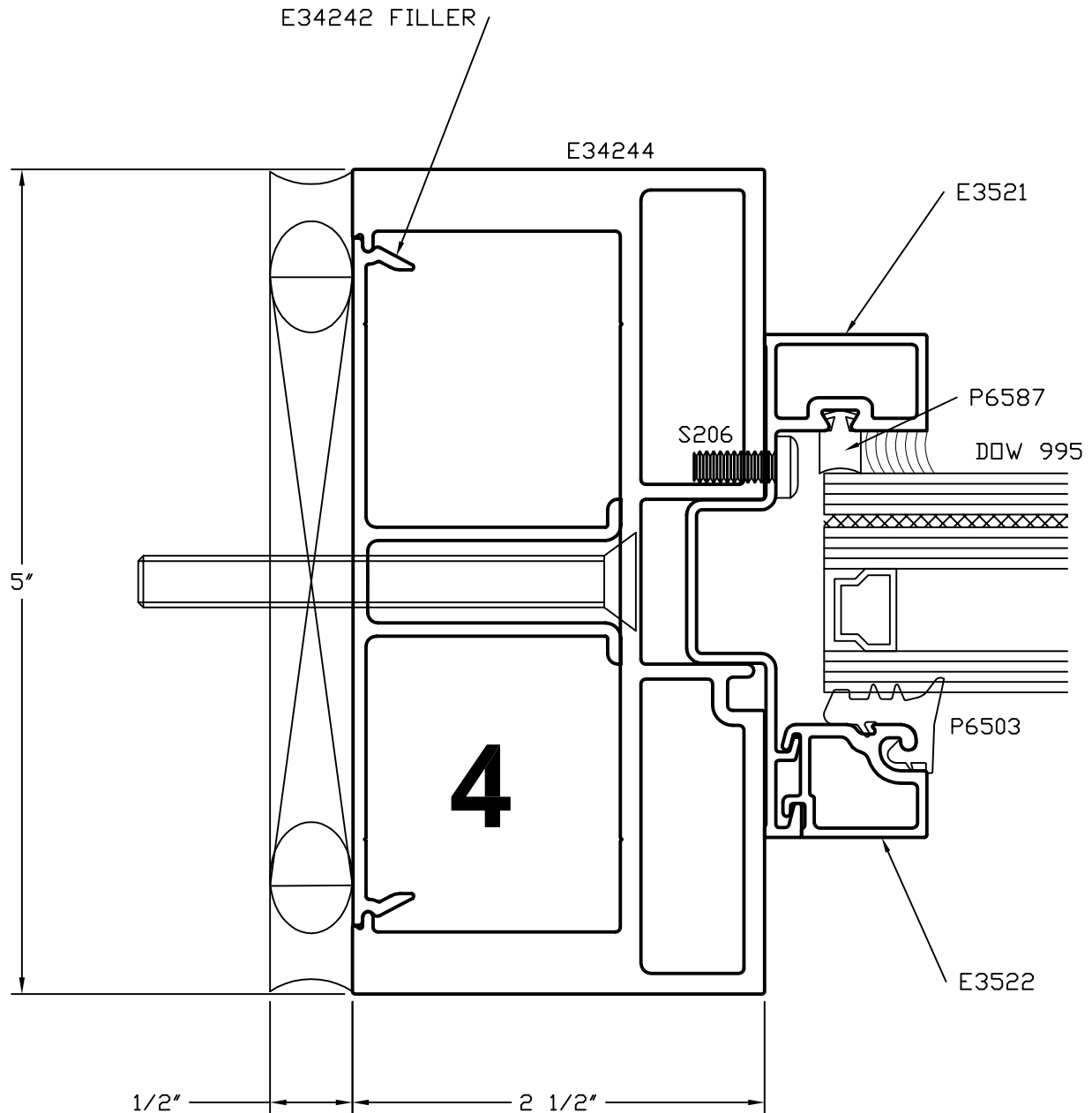

**6SD.21**  
**E34000 Series Hurricane Impact Storefront**  
**Wet Glaze, Non Thermal**  
**Door Jamb - Heavy Wall**  
**CAD File: 515DRJB1**

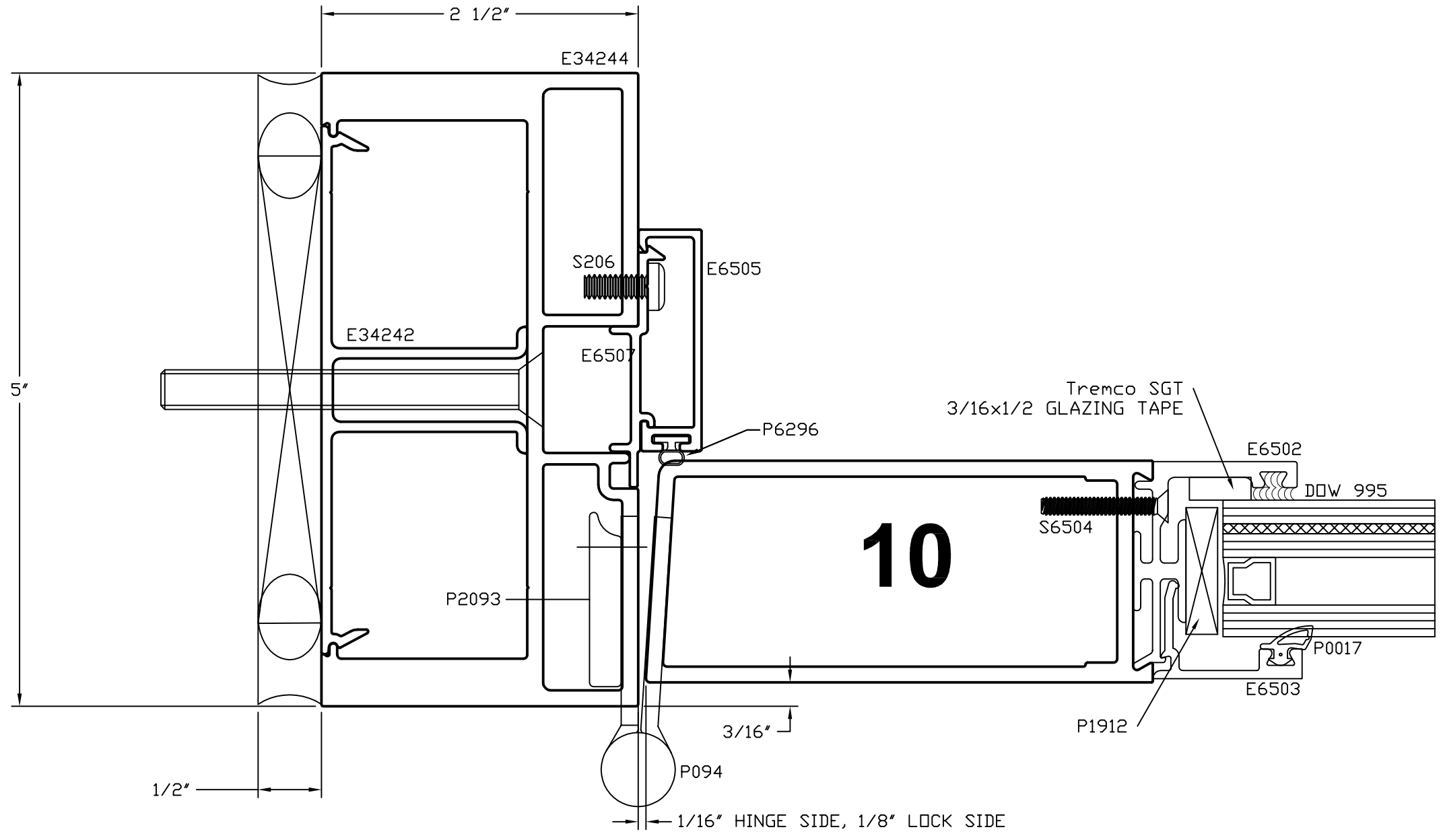

\*SEALANT, ROD, & ANCHORS NOT BY TUBELITE

**6SD.22**  
**E34000 Series Hurricane Impact Storefront**  
**Wet Glaze, Non Thermal**  
 Door Jamb  
 CAD File: 515DRJB2

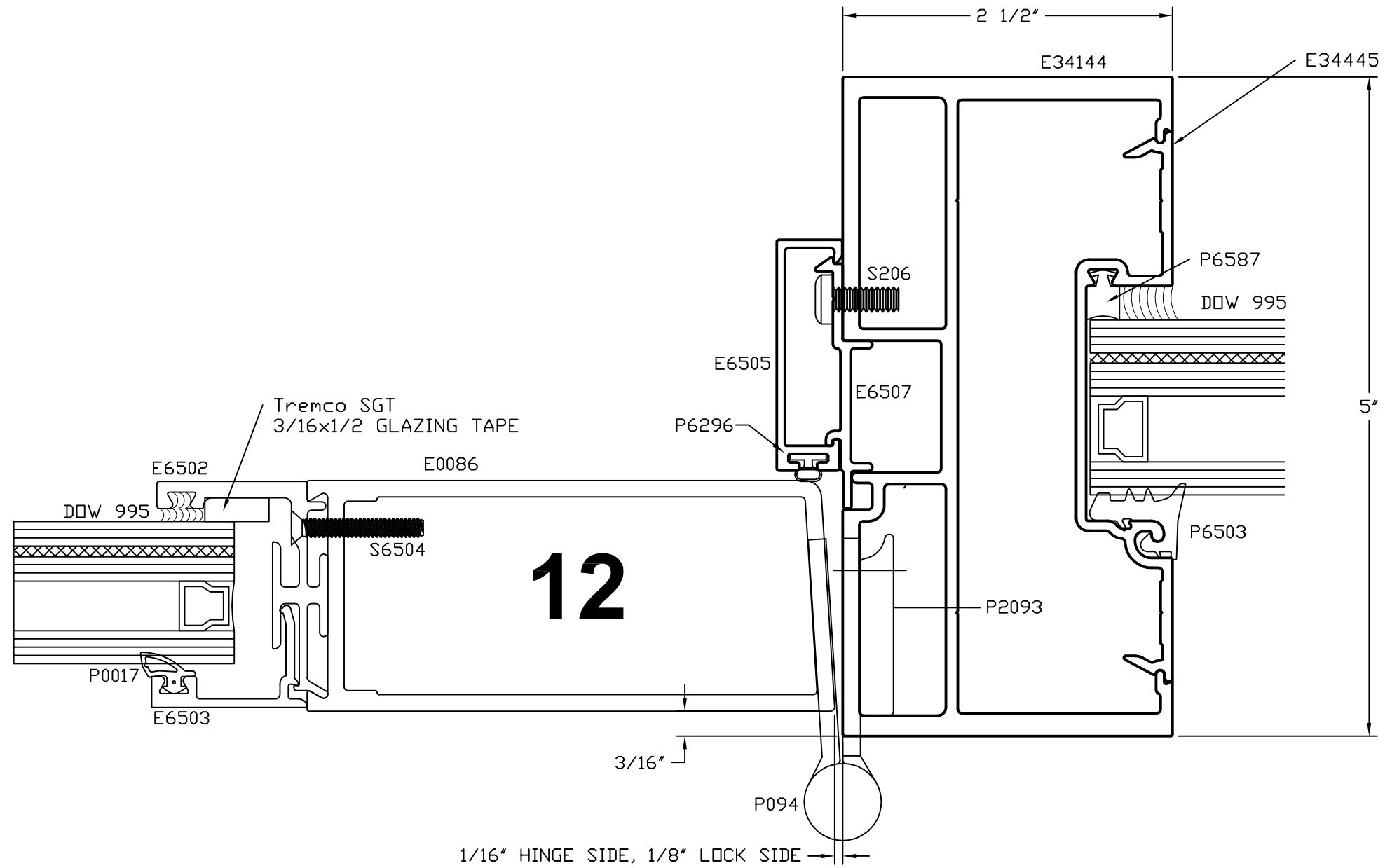

**6SD.23**  
**E34000 Series Hurricane Impact Storefront**  
**Wet Glaze, Non Thermal**  
**Transom Vertical**  
**CAD File: 515TRANVT2**

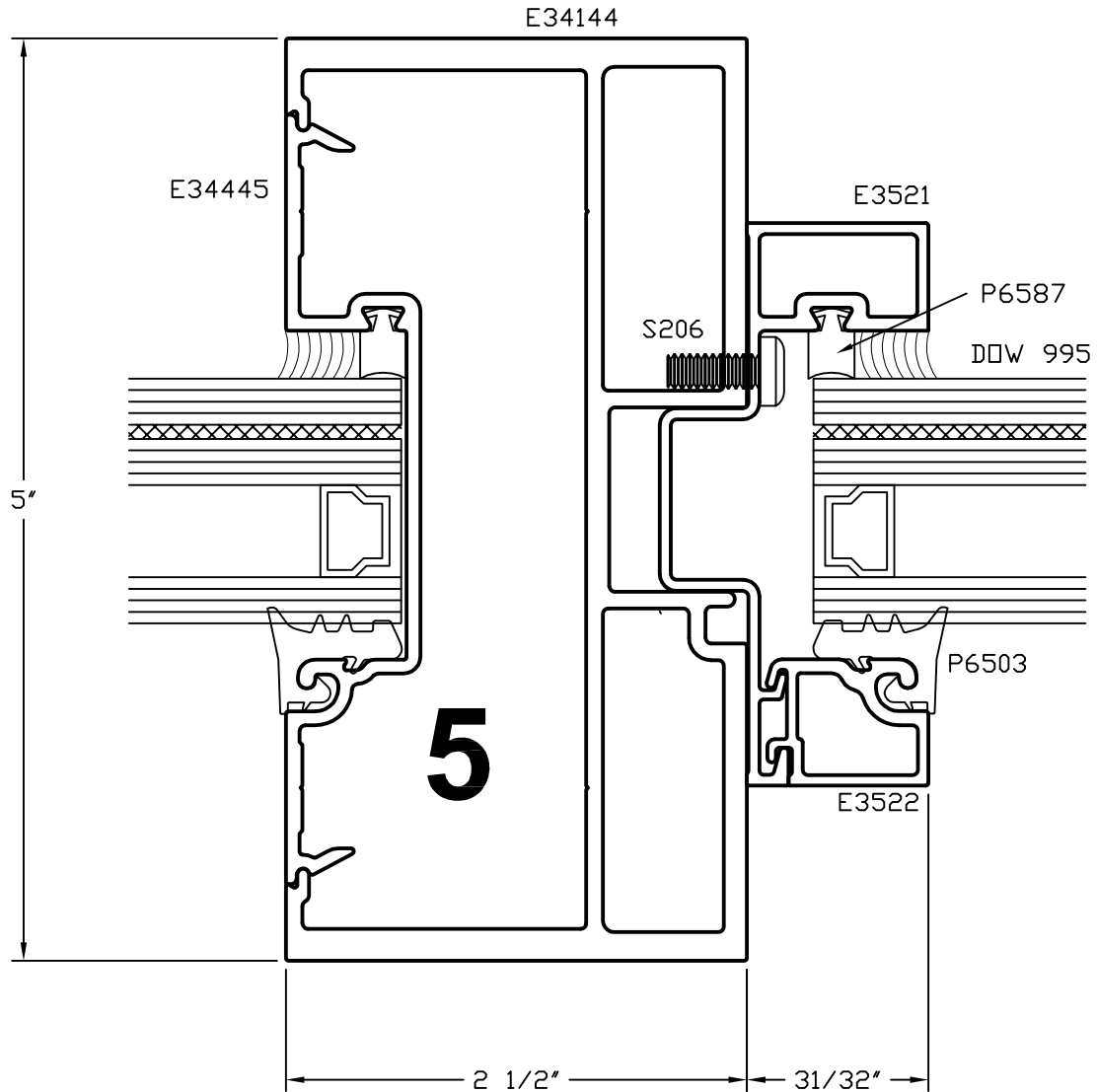

6SD.24

# E34000 Series Hurricane Impact Storefront

Wet Glaze, Non Thermal

Transom Vertical - Deep Pocket

CAD File: 515TRANVT3

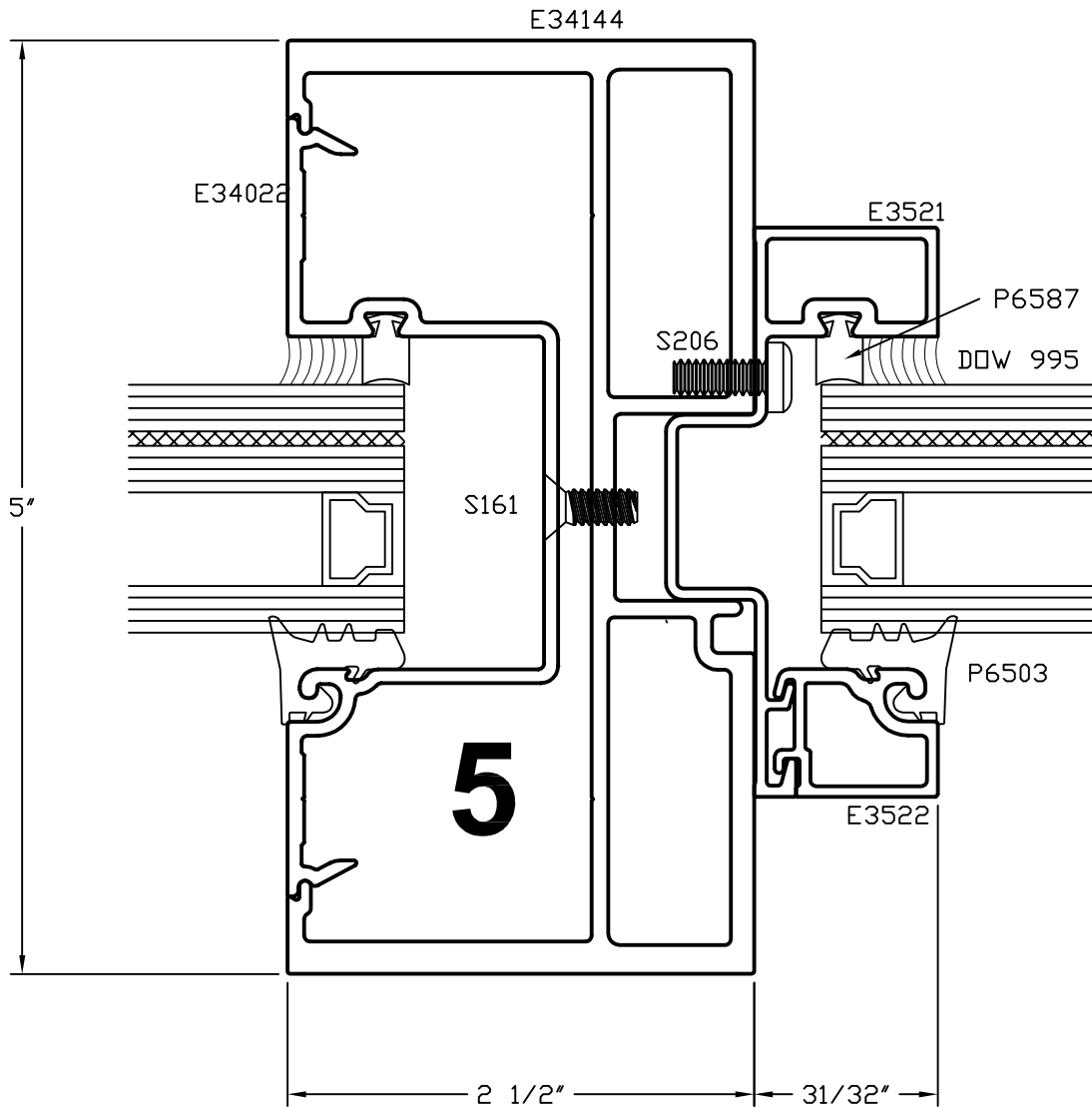

**TUBELITE**

DEPENDABLE

LEADERS IN ECO-EFFICIENT STOREFRONT,  
CURTAINWALL AND ENTRANCE SYSTEMS

2014

\*SEALANT, ROD, & ANCHORS NOT BY TUBELITE



**6SD.25**  
**E34000 Series Hurricane Impact Storefront**  
**Wet Glaze, Non Thermal**  
 Door Jamb - Deep Pocket  
 CAD File: 515DRJB3

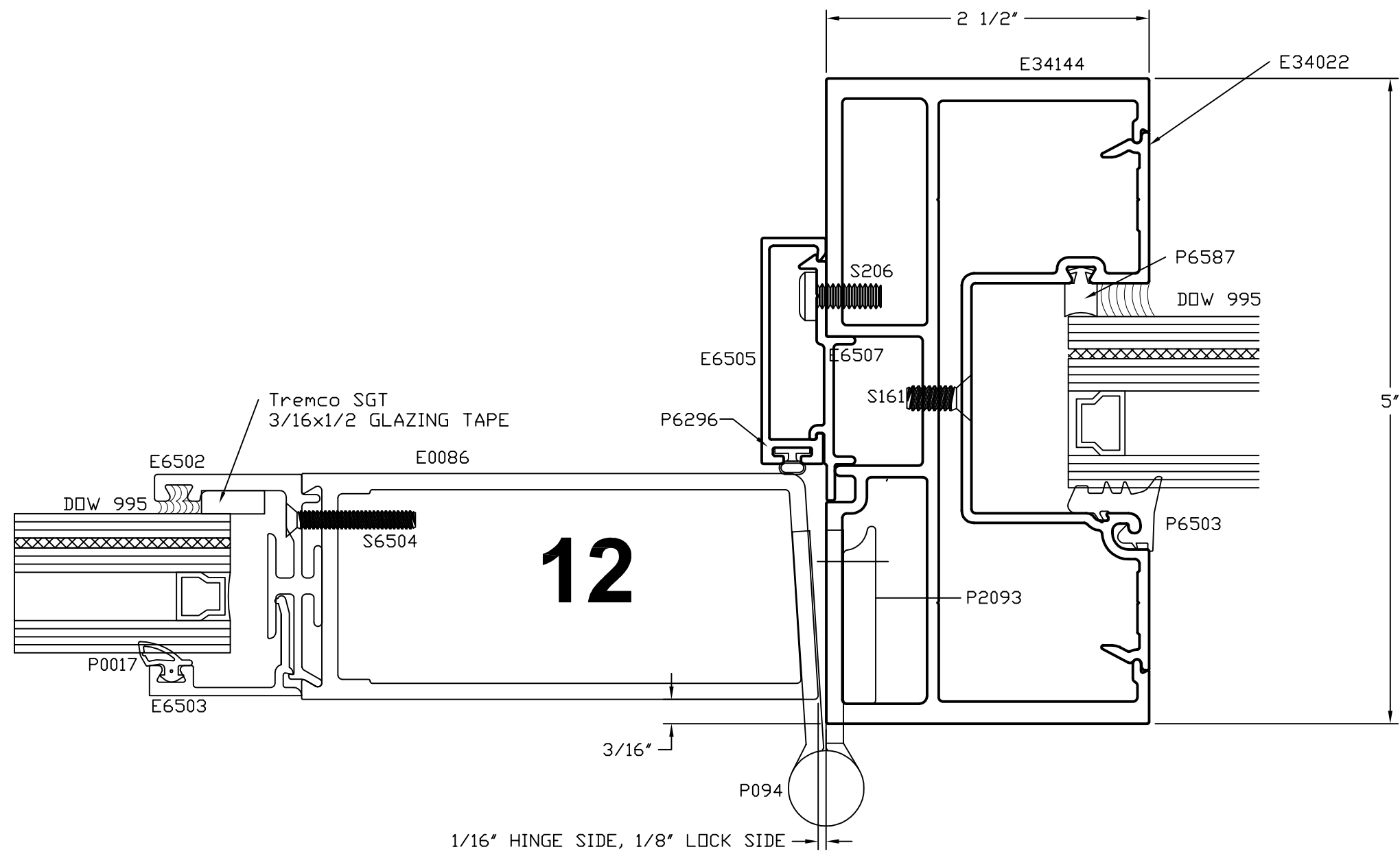

**6SD.26**  
**E34000 Series Hurricane Impact Storefront**  
**Wet Glaze, Non Thermal**  
**Door Jamb - Shallow Pocket**  
**CAD File: 515DRJB4**

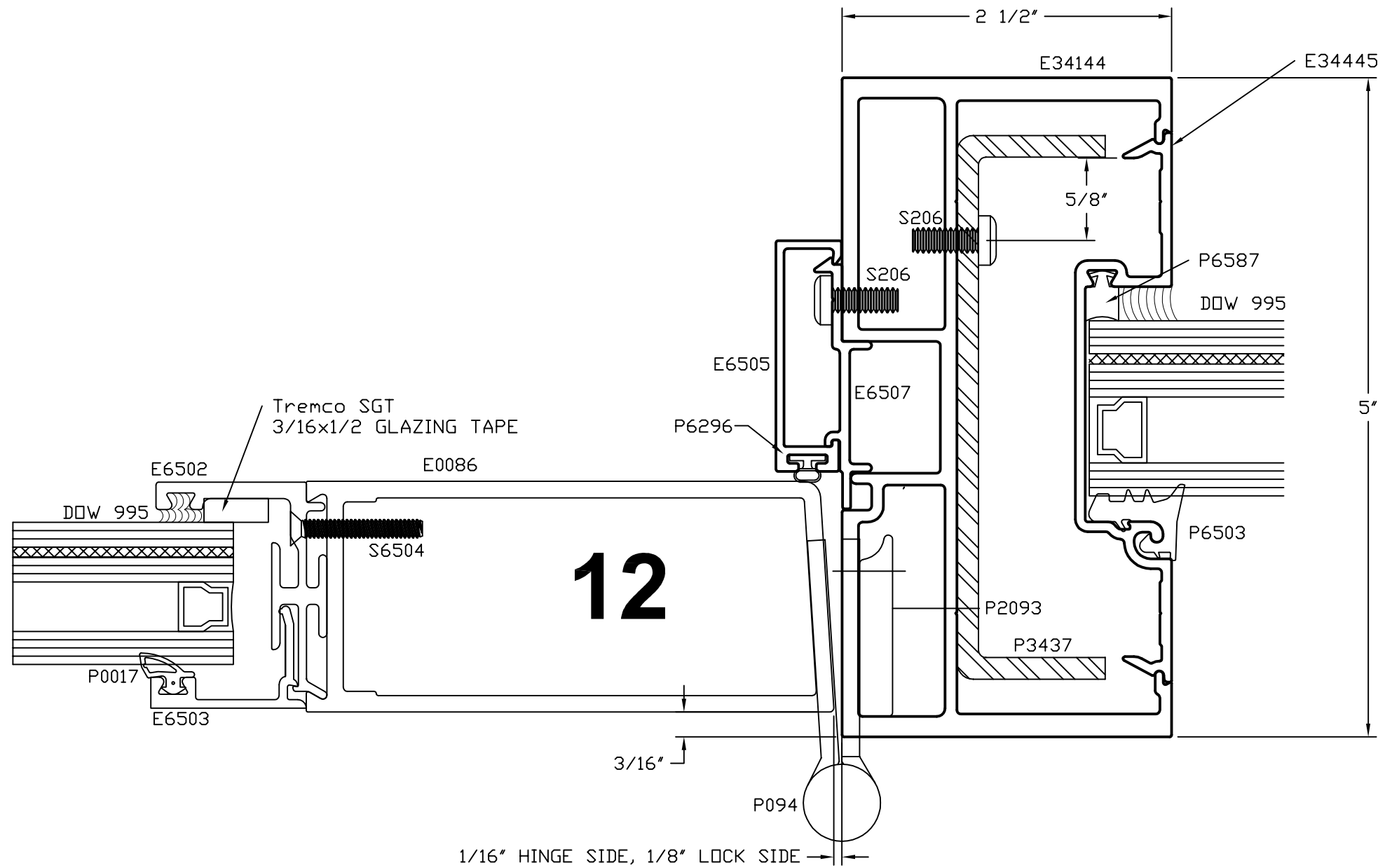

6SD.27

# E34000 Series Hurricane Impact Storefront

## Wet Glaze, Non Thermal

### Transom Vertical - Shallow Pocket

CAD File: 515TRANVT4

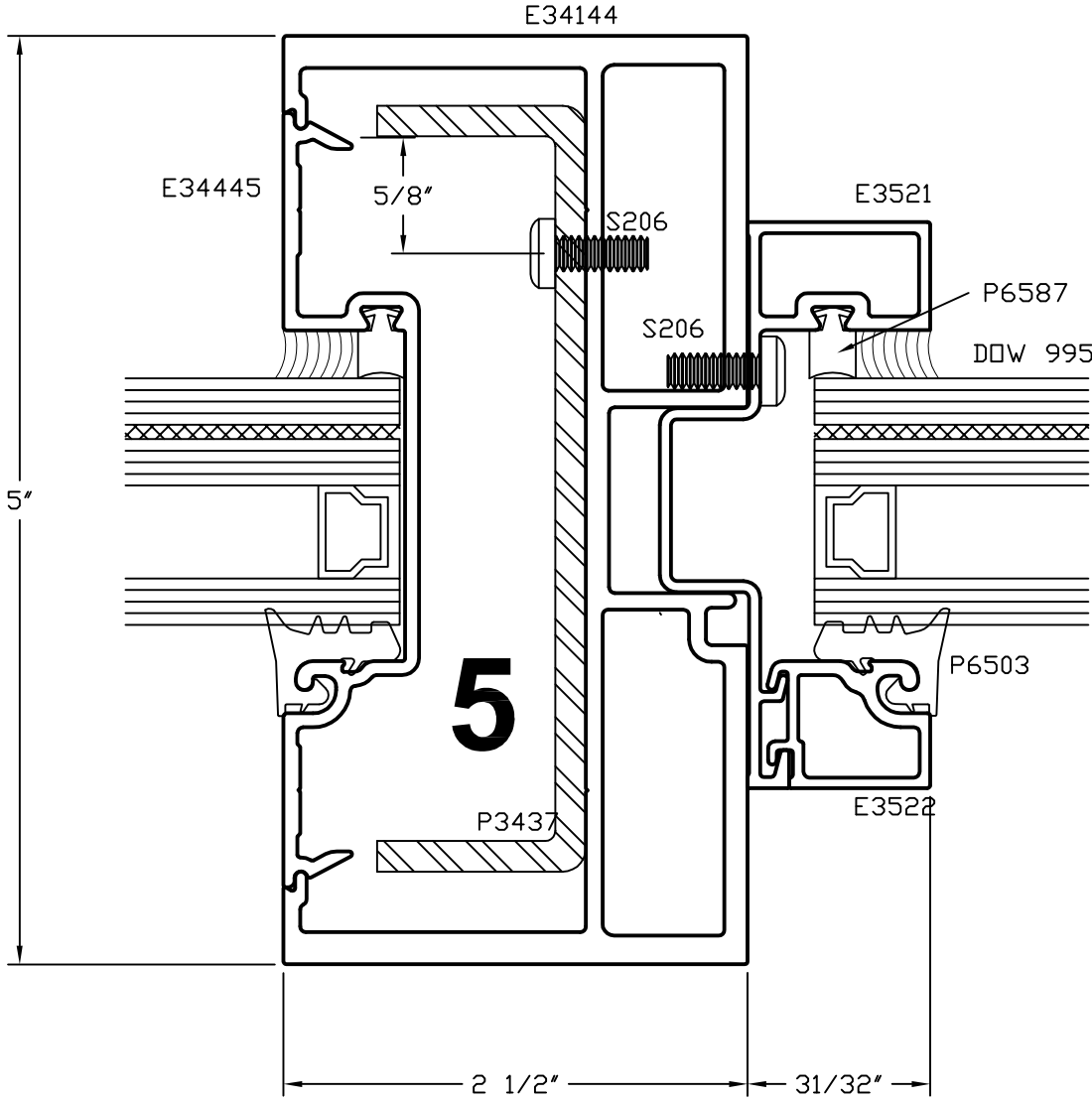

**TUBELITE**

DEPENDABLE

LEADERS IN ECO-EFFICIENT STOREFRONT,  
CURTAINWALL AND ENTRANCE SYSTEMS

2014

\*SEALANT, ROD, & ANCHORS NOT BY TUBELITE

6SD.28

# E34000 Series Hurricane Impact Storefront

Wet Glaze, Non Thermal

Transom Vertical - Deep Pocket

CAD File: 515TRANVT5

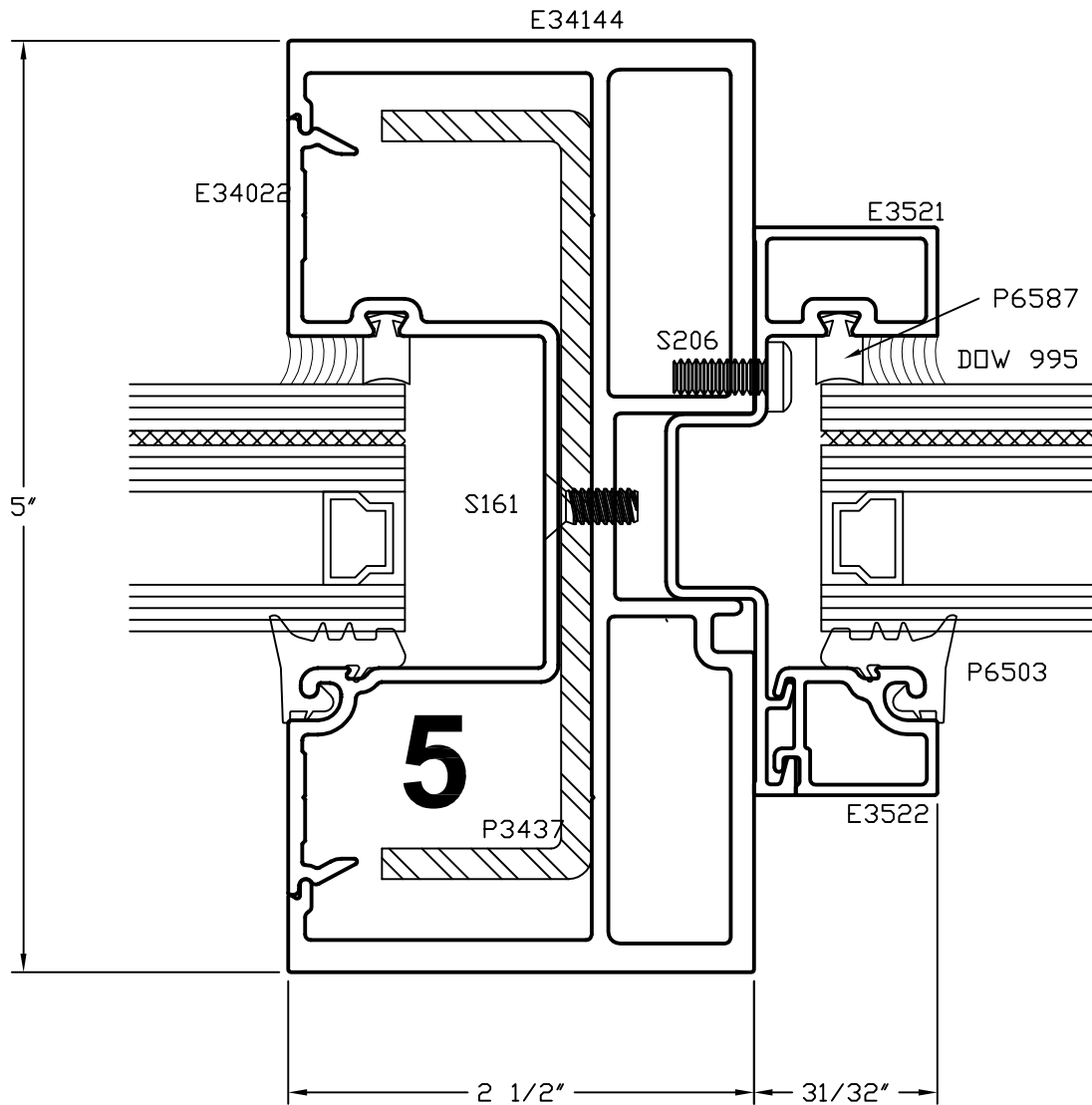

**TUBELITE**

DEPENDABLE

LEADERS IN ECO-EFFICIENT STOREFRONT,  
CURTAINWALL AND ENTRANCE SYSTEMS

2014

\*SEALANT, ROD, & ANCHORS NOT BY TUBELITE

**6SD.29**  
**E34000 Series Hurricane Impact Storefront**  
**Wet Glaze, Non Thermal**  
**Door Jamb**  
**CAD File: 515DRJB5**

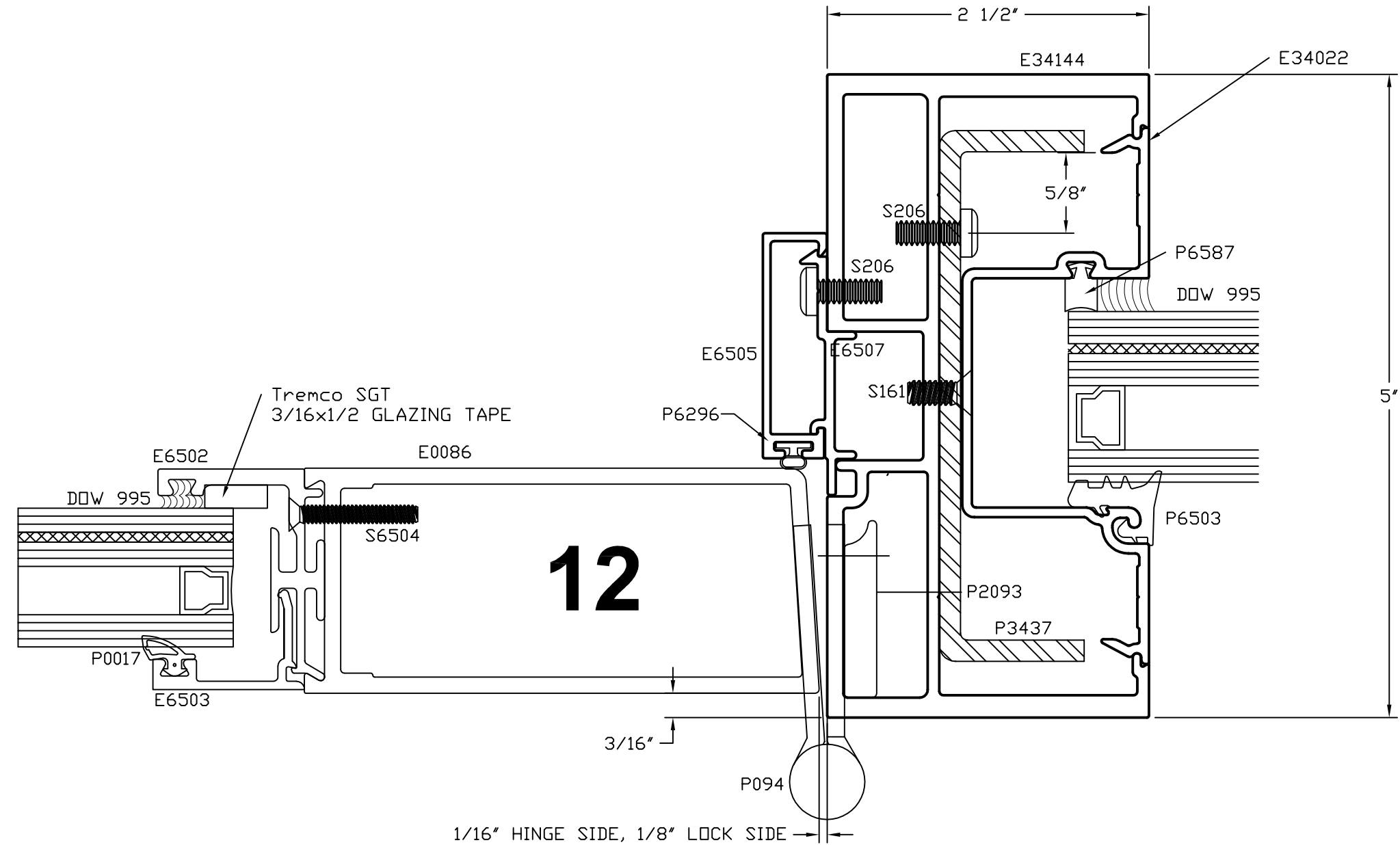

**6SD.30**  
**E34000 Series Hurricane Impact Storefront**  
**Wet Glaze, Non Thermal**  
 Door Jamb - Shallow Pocket  
 CAD File: 515DRJB6

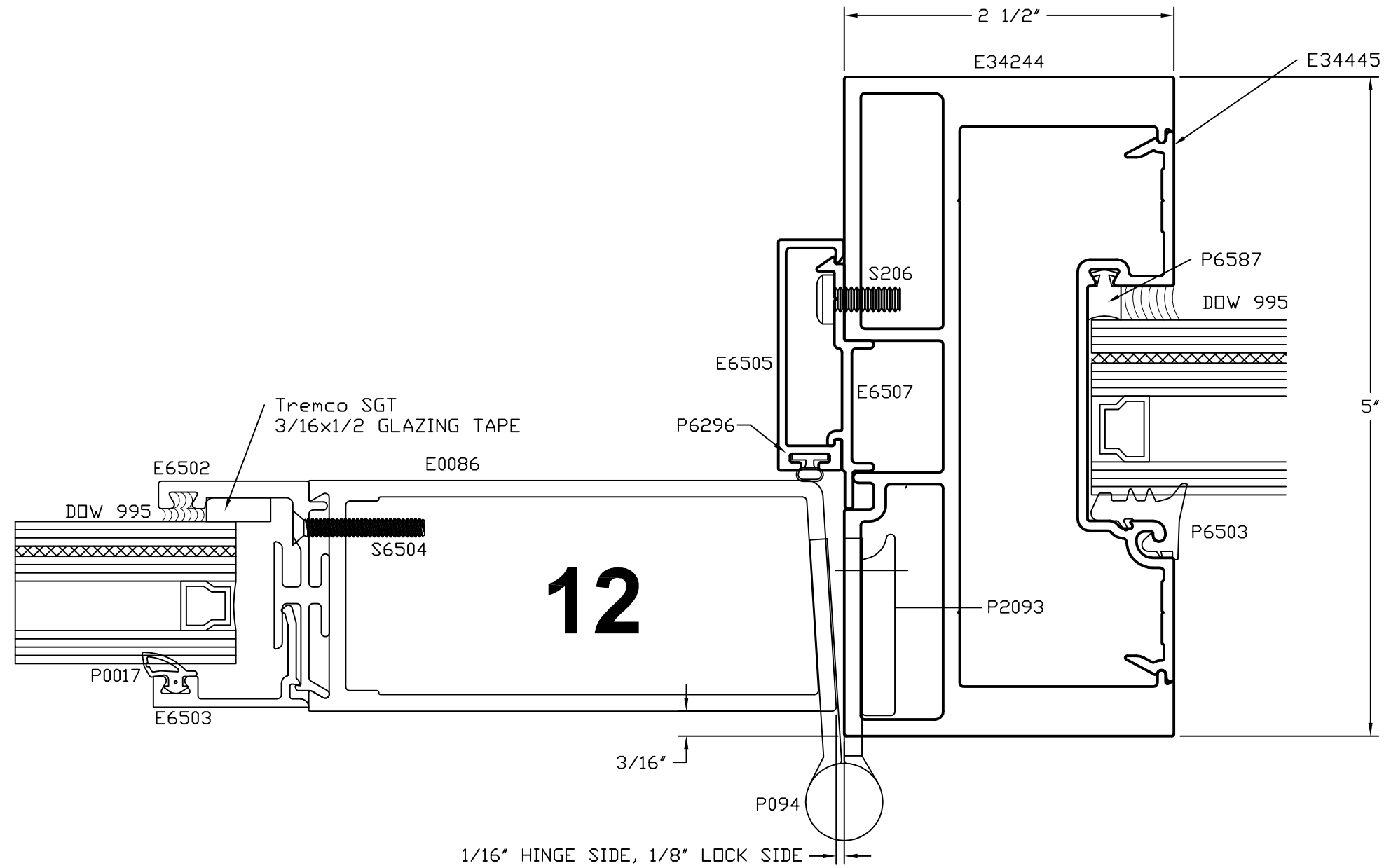

**6SD.31**  
**E34000 Series Hurricane Impact Storefront**  
**Wet Glaze, Non Thermal**  
**Transom Vertical - Heavy Wall**  
**CAD File: 515TRANVT6**

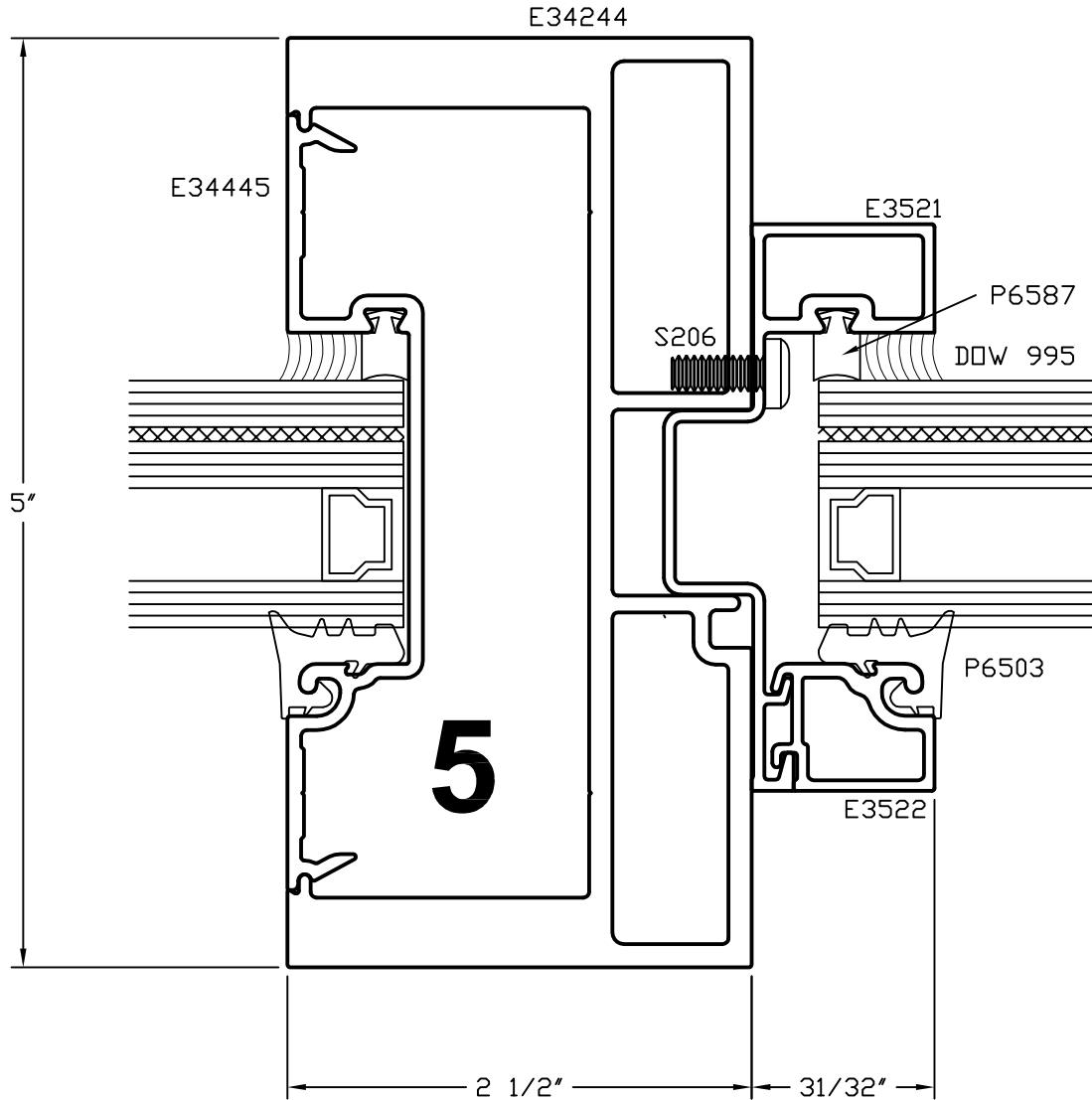

6SD.32

# E34000 Series Hurricane Impact Storefront Wet Glaze, Non Thermal

Transom Vertical- Heavy Wall - Deep Pocket

CAD File: 515TRANVT7

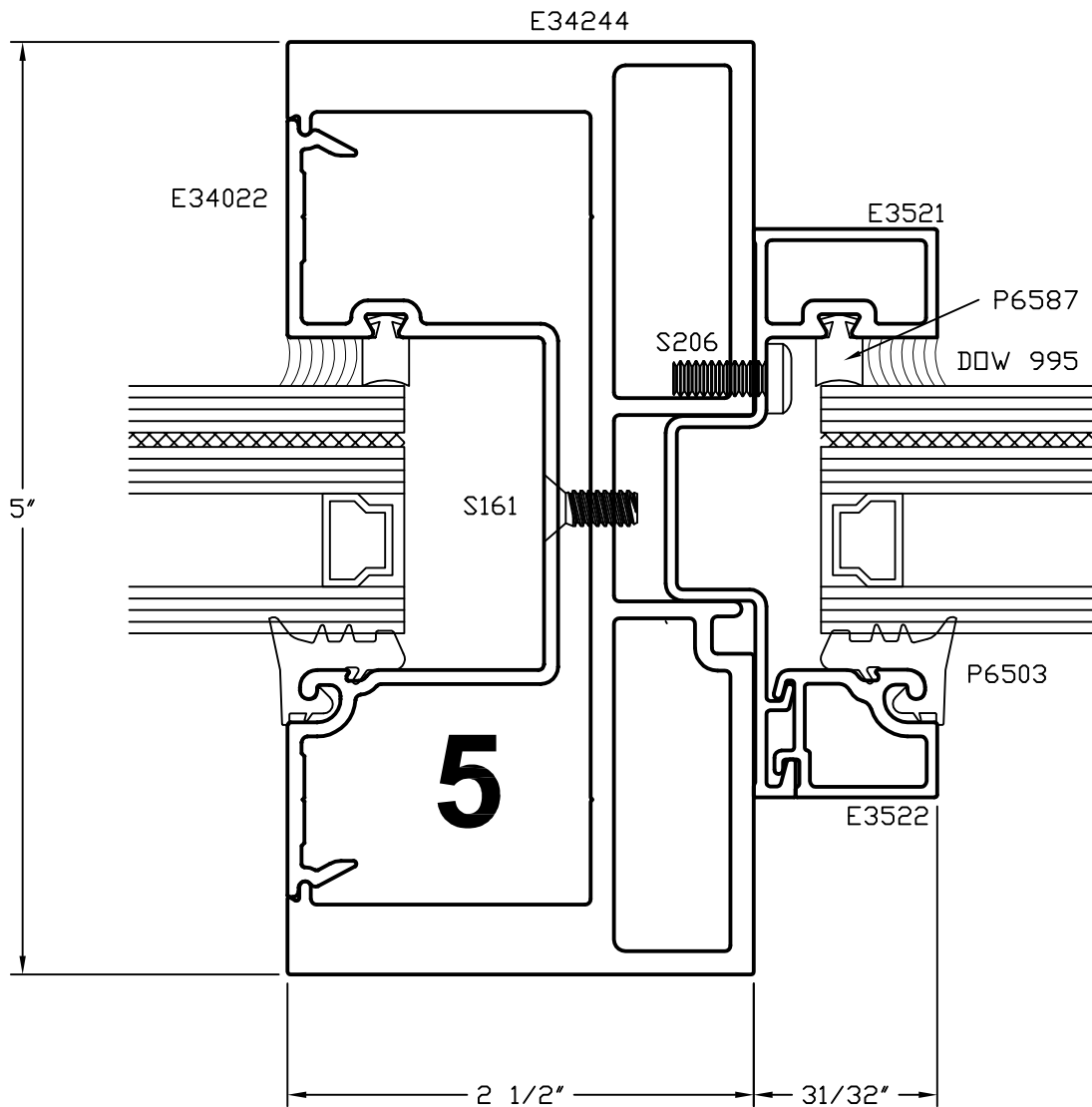

**TUBELITE**

DEPENDABLE

LEADERS IN ECO-EFFICIENT STOREFRONT,  
CURTAINWALL AND ENTRANCE SYSTEMS

2014

\*SEALANT, ROD, & ANCHORS NOT BY TUBELITE



**6SD.33**  
**E34000 Series Hurricane Impact Storefront**  
**Wet Glaze, Non Thermal**  
**Door Jamb - Deep Pocket**  
**CAD File: 515DRJB7**

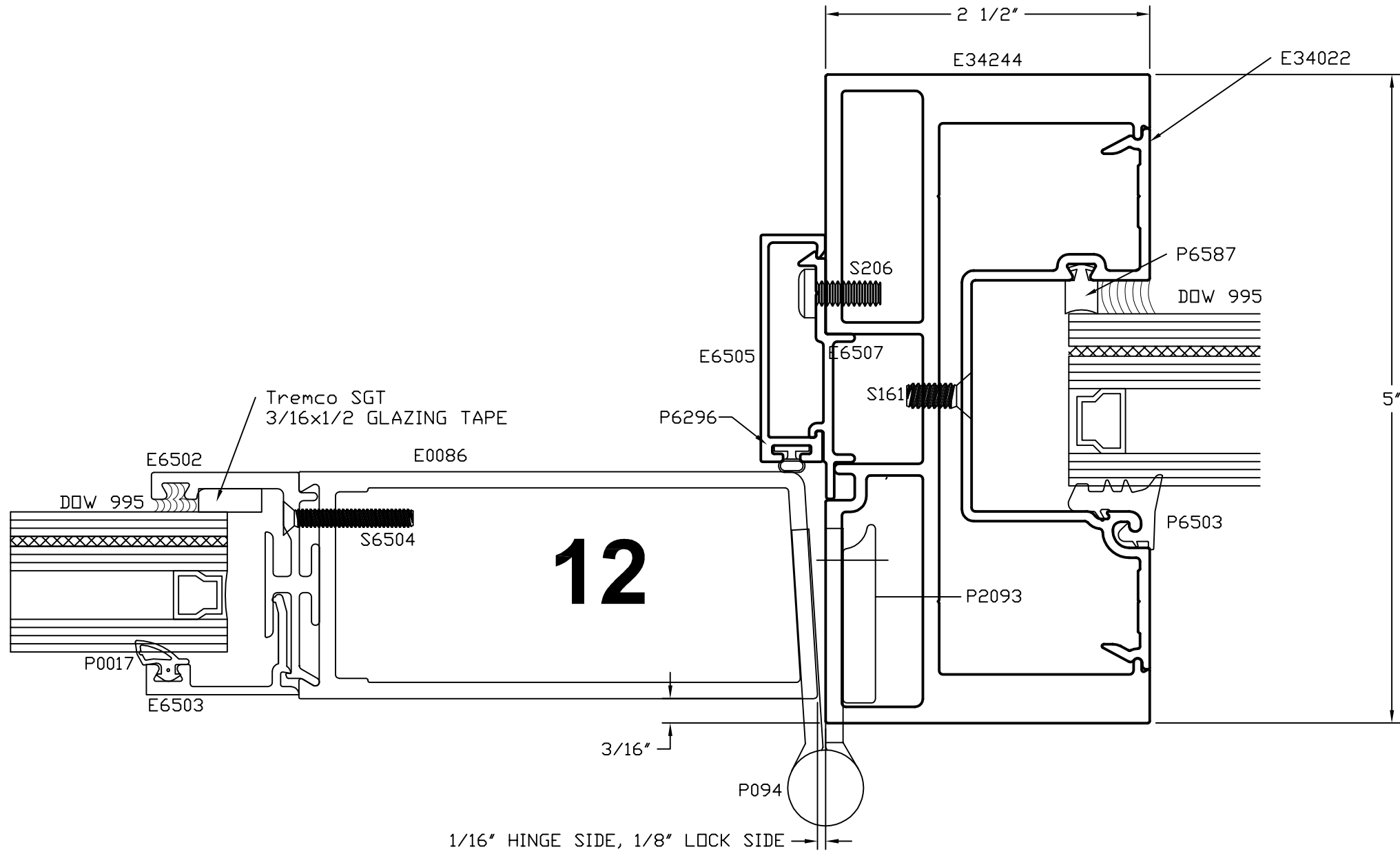

\*SEALANT, ROD, & ANCHORS NOT BY TUBELITE

**6SD.34**  
**E34000 Series Hurricane Impact Storefront**  
**Wet Glaze, Non Thermal**  
 Door Jamb - Shallow Pocket  
 CAD File: 515DRJB8

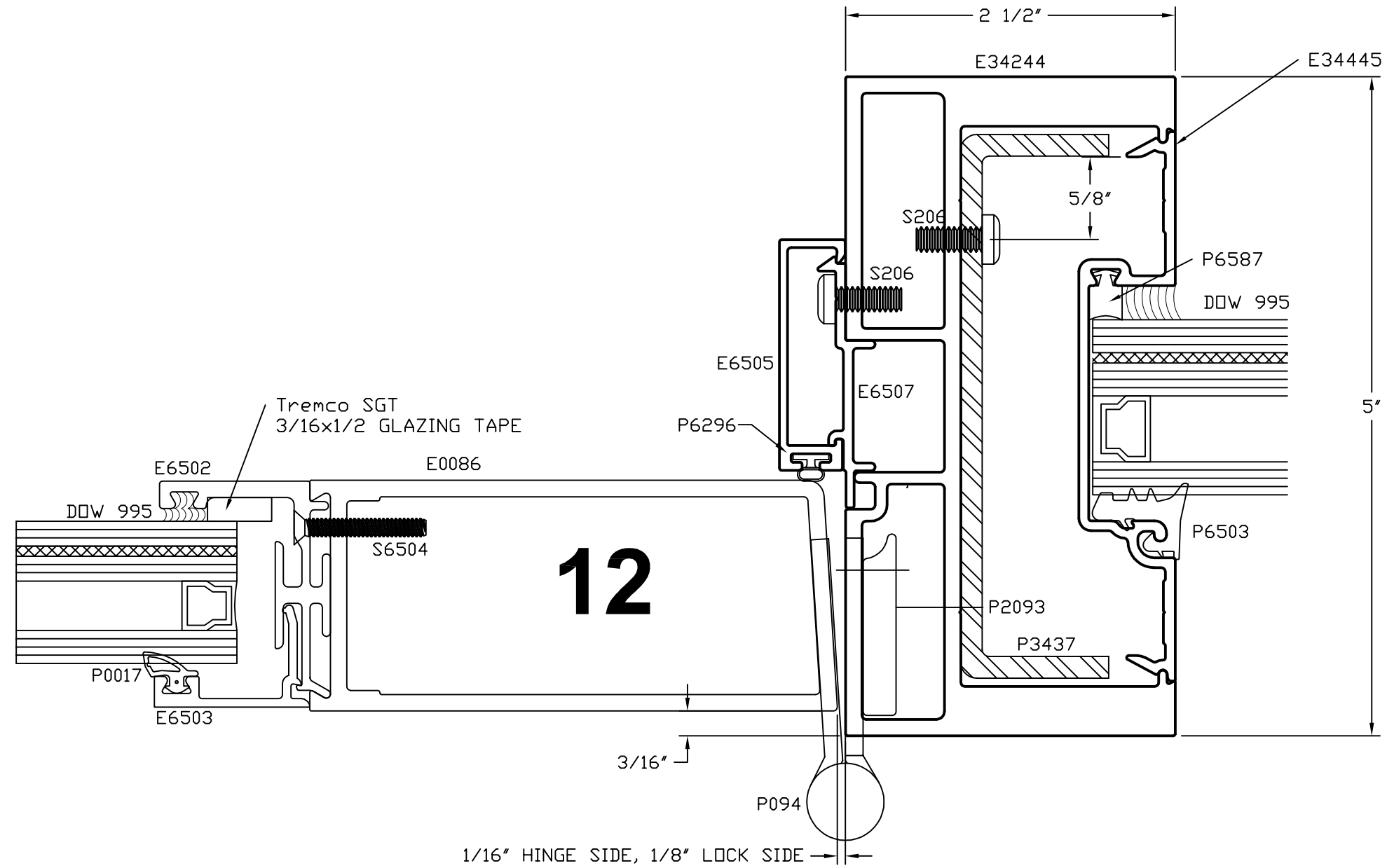

**6SD.35**  
**E34000 Series Hurricane Impact Storefront**  
**Wet Glaze, Non Thermal**  
**Transom Vertical - Heavy Wall**  
**CAD File: 515TRANVT8**

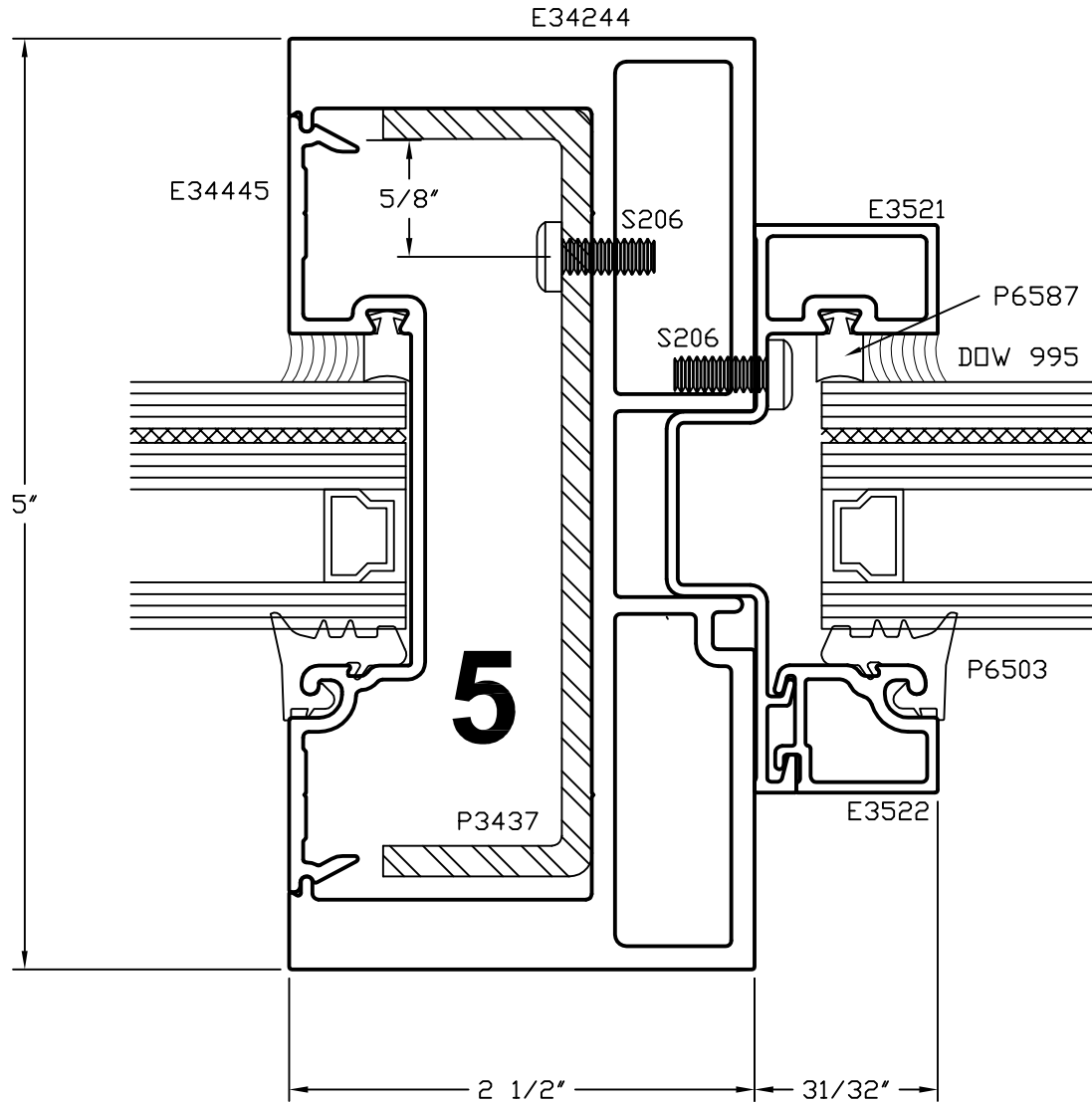

6SD.36

# E34000 Series Hurricane Impact Storefront

## Wet Glaze, Non Thermally Broken

Transom Vertical - Heavy Wall - Deep Pocket

CAD File: 515TRANVT9

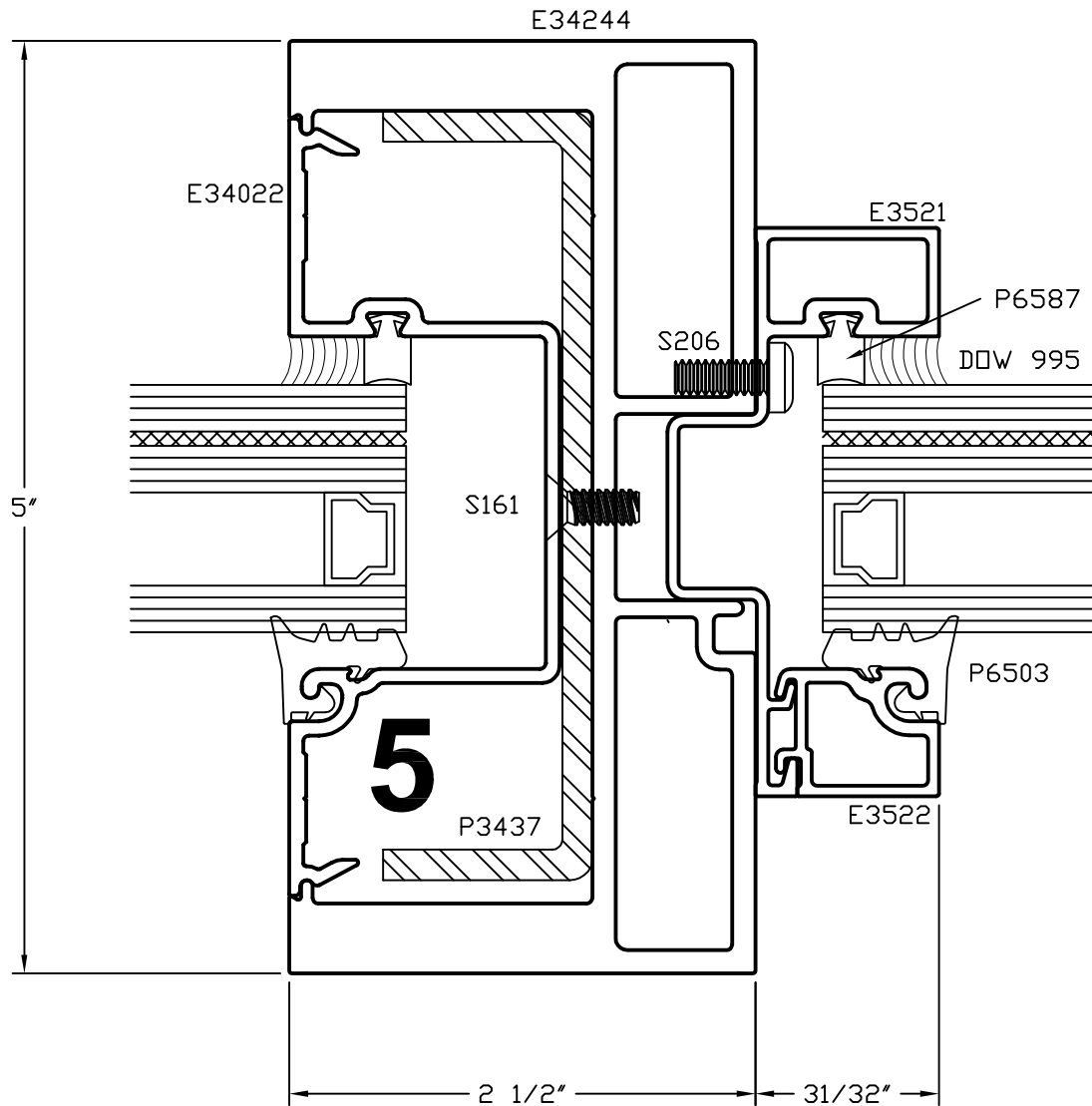

**TUBELITE**

DEPENDABLE

LEADERS IN ECO-EFFICIENT STOREFRONT,  
CURTAINWALL AND ENTRANCE SYSTEMS

2014

\*SEALANT, ROD, & ANCHORS NOT BY TUBELITE

**6SD.37**  
**E34000 Series Hurricane Impact Storefront**  
**Wet Glaze, Non Thermal**  
 Door Jamb  
 CAD File: 515DRJB9

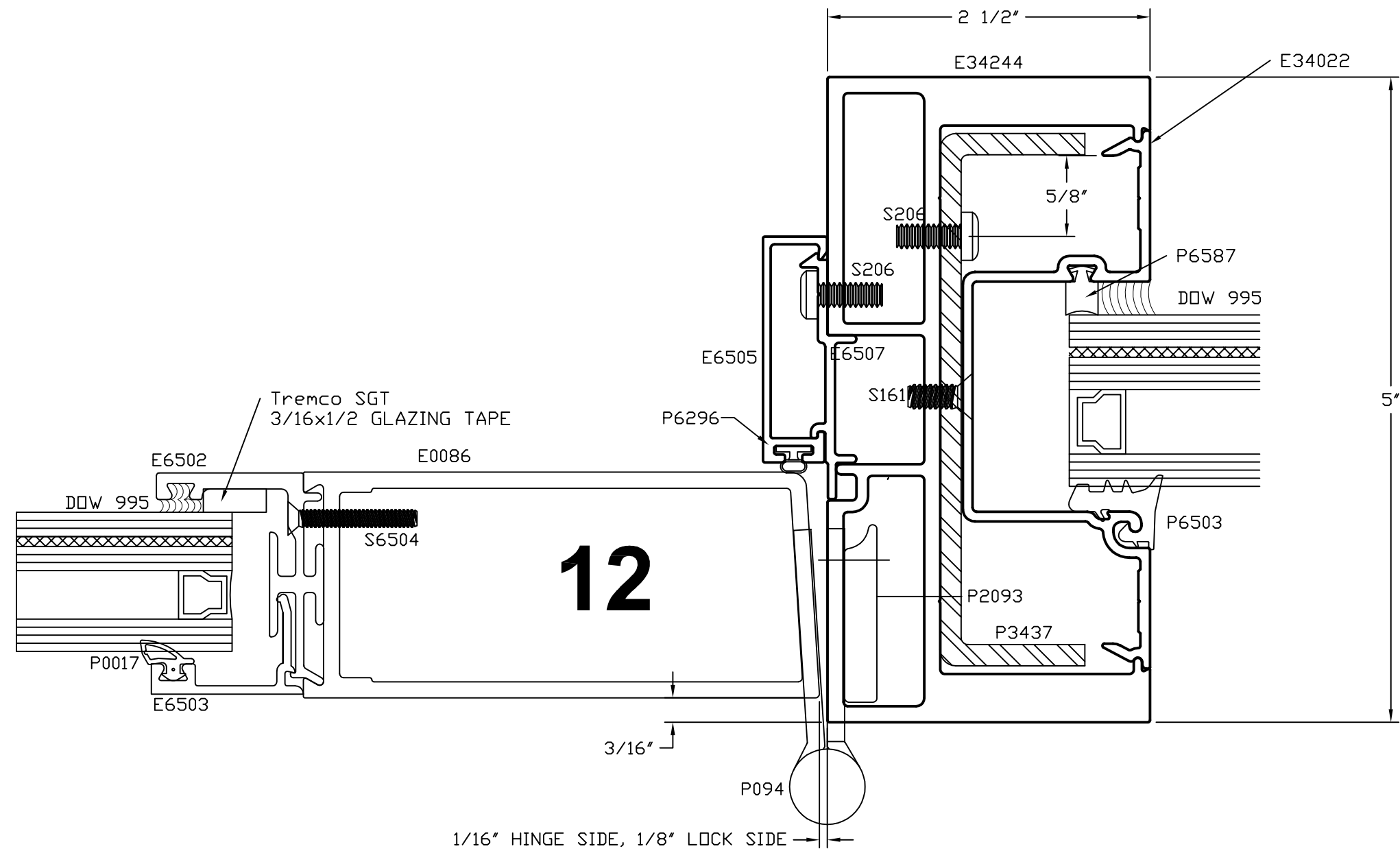

**6SD.38**  
**E34000 Series Hurricane Impact Storefront**  
**Wet Glaze, Non Thermal**  
**Meeting Stile**  
**CAD File: 515MEETST**

