

3700 Series Windows

Let fresh air into the building through a storefront or curtainwall. 3700 Series windows can be easily incorporated with Tubelite's other framing systems. Special glazing pocket adapters make installation a breeze.

These Curtainwall rated windows have a frame depth of 2" with a maximum size of 3'0" x 5'0" and mitred corners epoxied and crimped on an "L" shaped clip.

Standard and concealed project-out vent design, and casement options are available. The concealed vent design is virtually invisible from the outside of the building, with no visible frame. Screens are also available with frames finished to match the window.

CW 3700



CVW 3700



VW 3700



400 Series
Curtainwall



14000 Series
Storefront

ALSO
USED
WITH

TUBELITE[®]
DEPENDABLE

LEADERS IN ECO-EFFICIENT STOREFRONT,
CURTAINWALL AND ENTRANCE SYSTEMS

3700 Series Windows

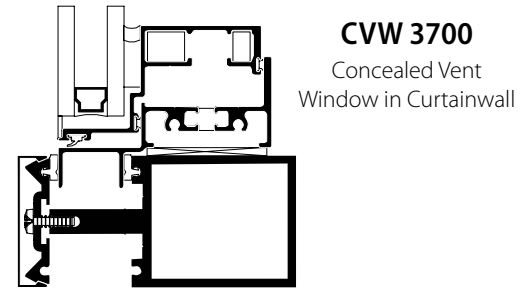
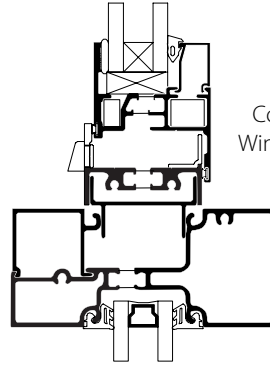
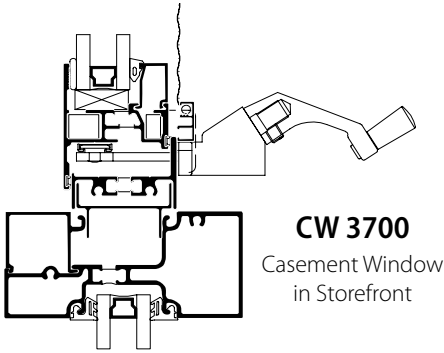

System Features:

- Standard 2-3/8" (60.325mm) sight line on frame members
- 2" (50.8mm) frame depth
- Single Pour & Debridge thermal break with Azon's Lancer® mechanical lock
- EPDM wedge type gaskets and glazing tape for 1" glass or panel thickness
- 4-bar hinges, Cam lock
- Florida Approval [Non-Impact]

Optional Features:

- Mitered, 2 Corner Keys, Lanced Stake & Silicone joints
- Conventional, Concealed and Casement window types
- Easily integrates with storefront or curtainwall framing systems
- 7 anodized and 19 painted standard finishes

3700 Series Windows	VW3700	CVW3700	CW3700
Application	Conventional Frame	Concealed Vent	Casement Type
Frame Joints	Screw-spline	Screw-spline	Screw-spline
Window Joints	Mitered, 2 Corner Keys, Lanced Stake & Silicone	Mitered, 2 Corner Keys, Lanced Stake & Silicone	Mitered, 2 Corner Keys, Lanced Stake & Silicone
Glass Thickness	1/4" & 1"	1"	1/4" & 1"
Face Width	2-3/8"	-	2-3/8"
Frame Depth	2"	3-1/2"	2"
Hardware	4-bar hinges, Cam lock	4-bar hinges, Cam lock	4-butt hinges, Cam lock, optional roto operator, 2-point egress lock, opening restrictor, egress pull-ring
Air Infiltration	0.10CFM/Ft.2 @ 6.24 PSF	0.10CFM/Ft.2 @ 6.24 PSF	0.10CFM/Ft.2 @ 6.24 PSF
Static Water	12 PSF	12 PSF	12 PSF
AAMA/WDMA/CSA 101 I.5.2/A440-08, NAFS Testing	CLASS CW-PG75 (60X36)-AP	CLASS CW-PG75 (61X38)-AP	CLASS CW-PG60 (26X60)-AP
Life Cycle Tested	2500 Cycles	2500 Cycles	2500 Cycles
CRF (AAMA 1503-2010)	56 _r / 67 _e	51 _r / 64 _e	59 _r / 68 _e
U-Factor**	0.47	0.56	0.46
Florida Approval (Non-Impact)	FL15420	FL15420	FL15421

** U-Factor per NFRC 100. Refer to the U-Value table at: www.tubeliteinc.com/products/operable-windows/

DISCLAIMER: Tubelite takes no responsibility for product selection or application, including, but not limited to, compliance with building codes, safety codes, laws, merchantability or fitness for a particular purpose; and further disclaims all liability for the use, in whole or in part, of this Technical Guide in preparation of project specifications and/or other documents. Technical Guides are subject to change at any time, without notice, and at Tubelite's sole discretion. ©2017 Tubelite Inc.

061120

TUBELITE®
DEPENDABLE

LEADERS IN ECO-EFFICIENT STOREFRONT,
CURTAINWALL AND ENTRANCE SYSTEMS

Tubelite reserves the right to change system configuration without prior notice when deemed necessary for product improvements.

Laws and building & safety codes governing the design and use of glazed entrance, window and curtain wall systems vary widely. Tubelite does not control the selection of product configurations, operating hardware or glazing materials, and assumes no responsibility thereof.

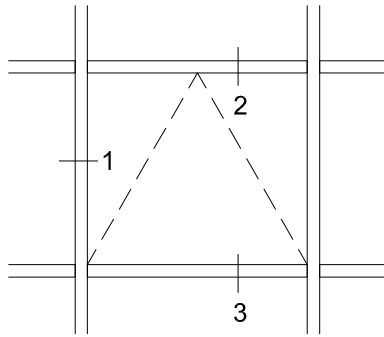

Standard Details
1/4 scale

Storefront Integration

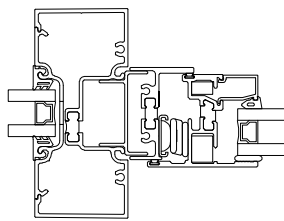

1

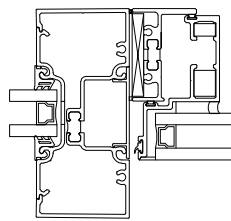

1

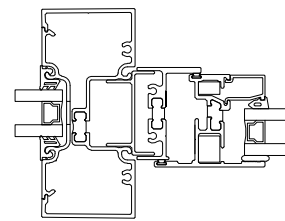

1

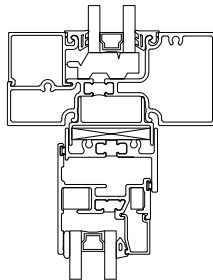

2

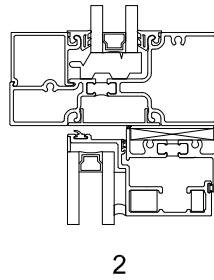

2

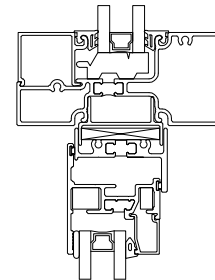

2

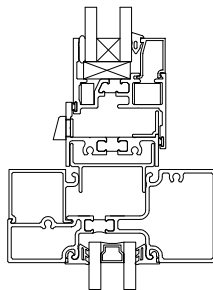

3

VW 3700

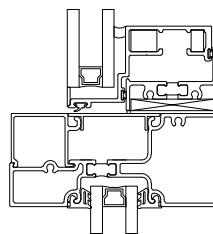

3

CVW 3700

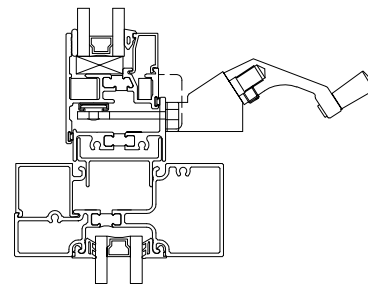

3

CW 3700

TUBELITE[®]
DEPENDABLE
LEADERS IN ECO-EFFICIENT STOREFRONT,
CURTAINWALL AND ENTRANCE SYSTEMS

January 2020

For specific product applications, contact your Tubelite representative.
Details on this page represent standard details found on our website.
For more options, visit our website at www.tubeliteinc.com/3700-series-windows/

Tubelite reserves the right to change system configuration without prior notice when deemed necessary for product improvements.

Laws and building & safety codes governing the design and use of glazed entrance, window and curtain wall systems vary widely. Tubelite does not control the selection of product configurations, operating hardware or glazing materials, and assumes no responsibility thereof.

Standard Details
1/4 scale

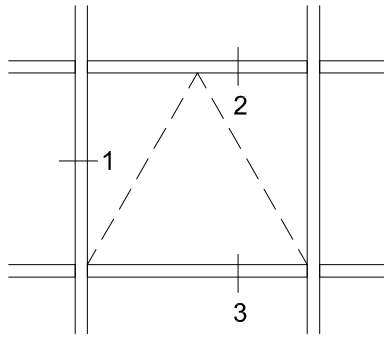

Curtain Wall Integration

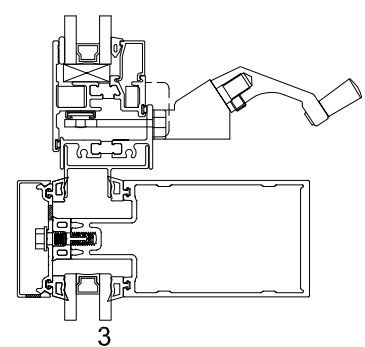
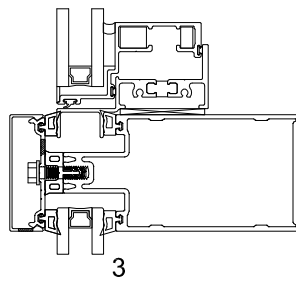
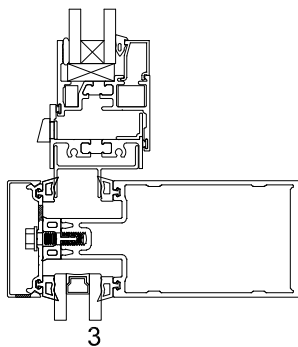
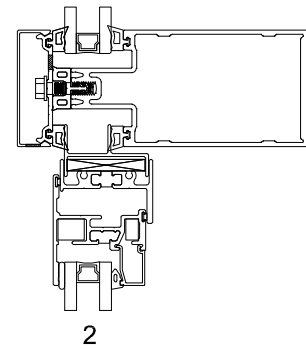
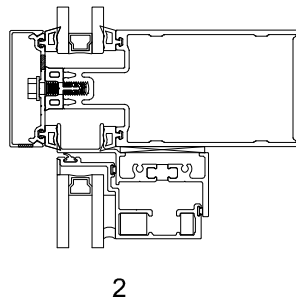
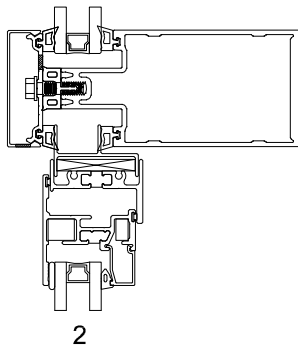
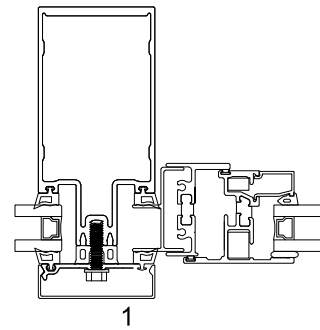
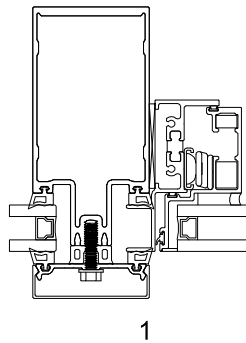
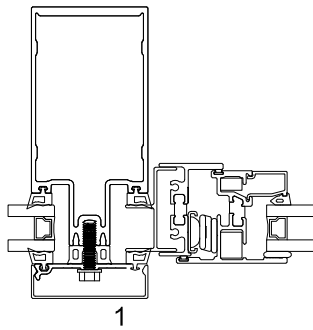

VW 3700

CVW 3700

VW 3700

TUBELITE[®]
DEPENDABLE
LEADERS IN ECO-EFFICIENT STOREFRONT,
CURTAINWALL AND ENTRANCE SYSTEMS

January 2020

For specific product applications, contact your Tubelite representative.
Details on this page represent standard details found on our website.
For more options, visit our website at www.tubeliteinc.com/3700-series-windows/

Tubelite reserves the right to change system configuration without prior notice when deemed necessary for product improvements.

Laws and building & safety codes governing the design and use of glazed entrance, window and curtain wall systems vary widely. Tubelite does not control the selection of product configurations, operating hardware or glazing materials, and assumes no responsibility thereof.

Standard Details
1/4 scale

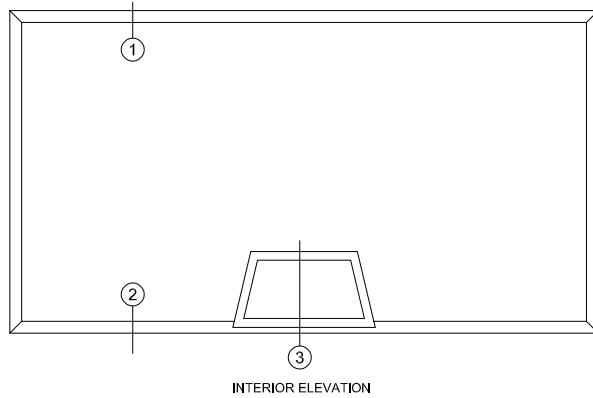

INTERIOR ELEVATION

Screens

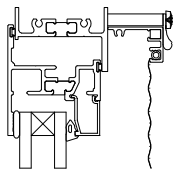

1

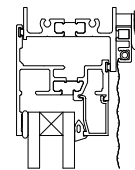

1

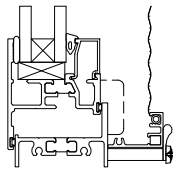

2

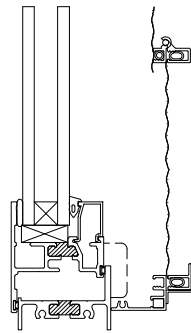

3

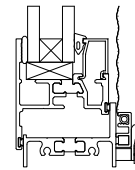

2

January 2020

TUBELITE[®]
DEPENDABLE
LEADERS IN ECO-EFFICIENT STOREFRONT,
CURTAINWALL AND ENTRANCE SYSTEMS

For specific product applications, contact your Tubelite representative.
Details on this page represent standard details found on our website.
For more options, visit our website at www.tubeliteinc.com/3700-series-windows/