

Tubelite® 400IG Curtainwall

400IG (Inside Glazed) Curtainwall Framing for low and medium rise applications has been redesigned for installation labor savings and design flexibility. Offset glass pockets and removable glass stops allow glazing or re-glazing from both the exterior and interior of the building.

Broken lites can be replaced without removing the vertical pressure plates or snap covers. The new roll-over horizontal member permits erection of all the verticals first, to reduce installation time and cost. Open back head and jamb members provide economical alternatives to the previous hollow tube perimeters.



*Tubelite 400CW Curtainwall, Wide Stile Doors Entrance;
The Dunlavy; Houston, TX
Architect: Page*

**Standard Medium
Stile Entrances**

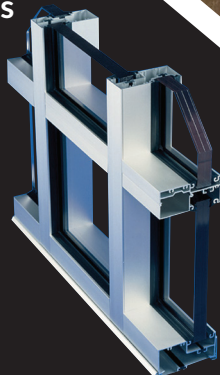

**ALSO
USED
WITH**

**14000 I/O Series
Multiplane
Storefront Framing**

TUBELITE®
DEPENDABLE

LEADERS IN ECO-EFFICIENT STOREFRONT,
CURTAINWALL AND ENTRANCE SYSTEMS

Tubelite® 400IG Curtainwall

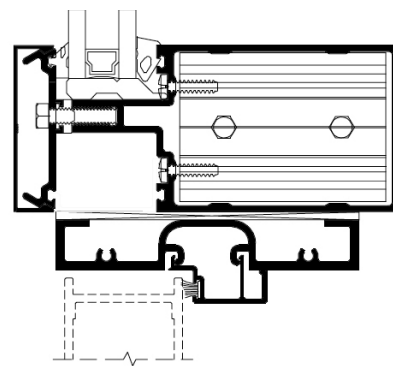
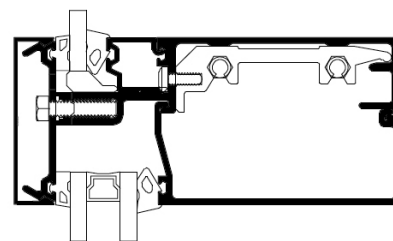
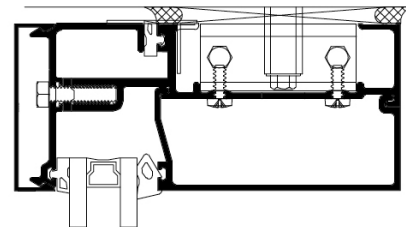
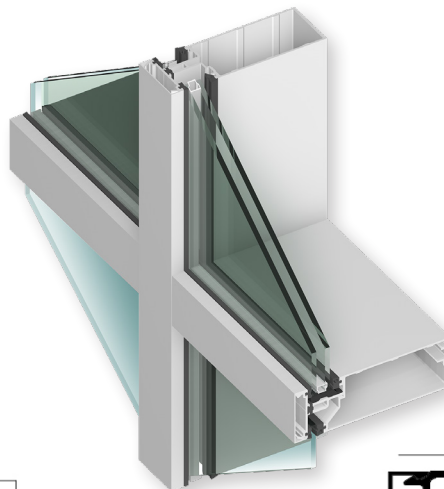
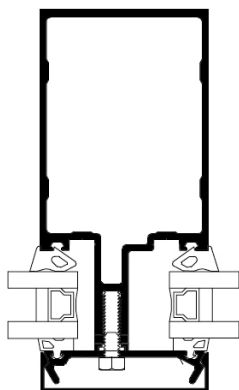
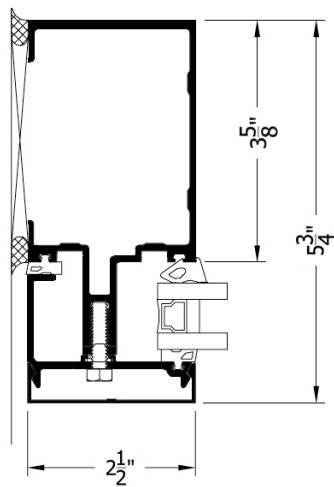

System Features:

- Standard 6" (152.4mm) 7-1/2" and 10" depth systems have a 2-1/2" (63.5mm) sight line
- Outside glazed pressure-plate system available in captured and structural glazed configurations
- Standard infill option 1" (25.4mm), other infills available
- Thermally Improved using a continuous 1/8" (3.2mm) EPDM Isolator
- Can be shop-fabricated and shop-glazed for labor savings
- Silicone compatible glazing materials for long-lasting seals
- Captured & SSG inside and outside corners available

Optional Features:

- Steel reinforcing available
- Optional deep profile and bull nose covers available
- Silicone glazed intermediate verticals & horizontals available
- Polyamide pressure plates available
- Easily integrates with Tubelite's, Entrances, 3700 and Phantom 5000 Insert Vents, Maxblock Sunshades, and aLuminate Light Shelves
- Deep and heavy-weight mullions available

400IG Curtainwall Product Specifications

Application: Low and mid-rise commercial buildings including retail, office, healthcare, schools, etc.

Description: 2-1/2" x 5-3/4" or 7-3/8" field glazed, inside glazed, shear block construction curtainwall

Face Width:	Overall Depths:	Glass:	Air Infiltration:	Water Infiltration:	Structural:	CRF :
2-1/2"	5-3/4" 7-3/8"	1" (1/8" to 1-5/16")	0.06 CFM/Ft.2 @ 6.24 PSF	15 PSF – Static 12 PSF – Dynamic	30 PSF – Design 45 PSF – Overload	63 _p 56 _c

DISCLAIMER: Tubelite takes no responsibility for product selection or application, including, but not limited to, compliance with building codes, safety codes, laws, merchantability or fitness for a particular purpose; and further disclaims all liability for the use, in whole or in part, of this Technical Guide in preparation of project specifications and/or other documents. Technical Guides are subject to change at any time, without notice, and at Tubelite's sole discretion. ©2018 Tubelite Inc.

113020

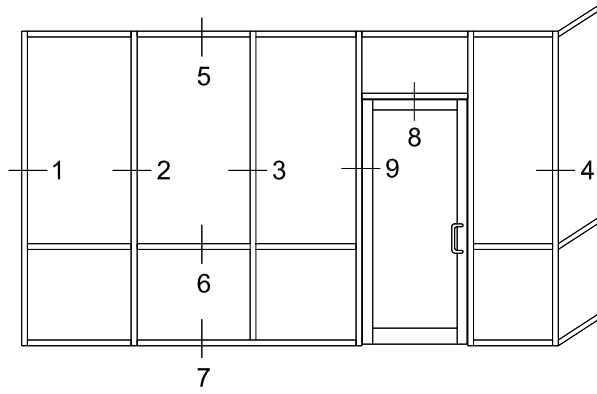

Tubelite reserves the right to change system configuration without prior notice when deemed necessary for product improvements.

Laws and building & safety codes governing the design and use of glazed entrance, window and curtain wall systems vary widely. Tubelite does not control the selection of product configurations, operating hardware or glazing materials, and assumes no responsibility thereof.

Standard Details
1/4 scale

INSIDE GLAZE

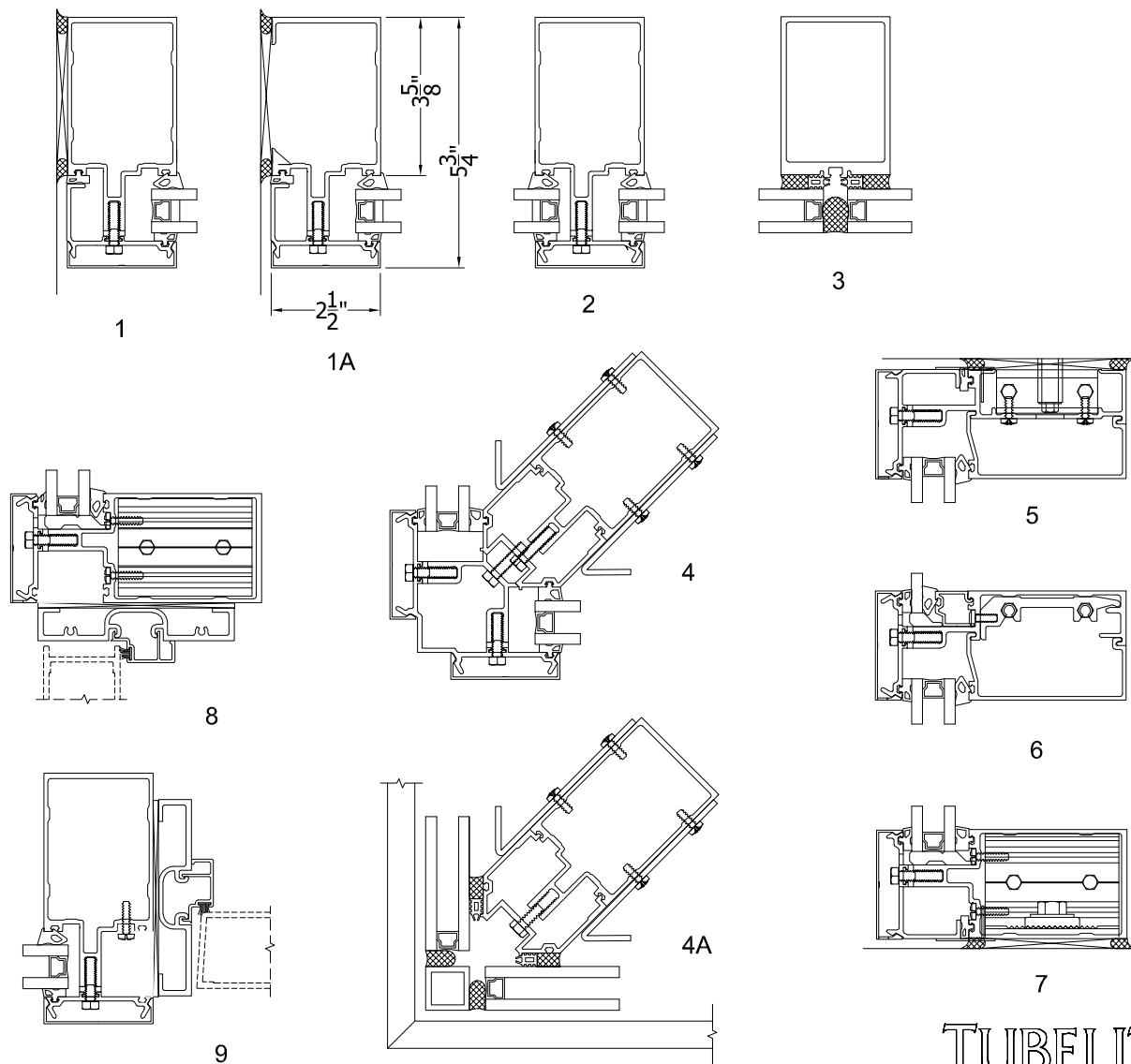

December 2017

TUBELITE[®]
DEPENDABLE
LEADERS IN ECO-EFFICIENT STOREFRONT,
CURTAINWALL AND ENTRANCE SYSTEMS

For specific product applications, contact your Tubelite representative. Details on this page represent standard details found on our website. For more options, visit our website at [www.tubeliteinc.com/\[product\]/](http://www.tubeliteinc.com/[product]/)

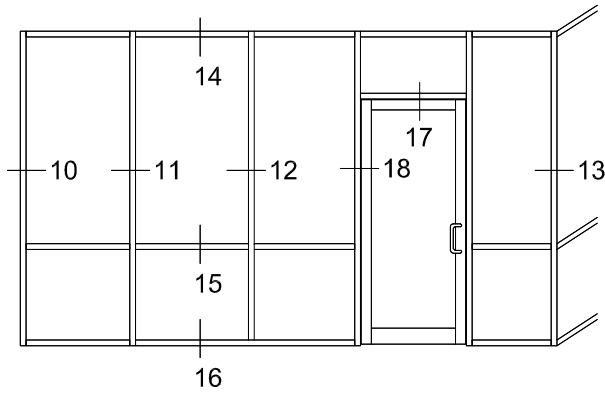

Tubelite reserves the right to change system configuration without prior notice when deemed necessary for product improvements.

Laws and building & safety codes governing the design and use of glazed entrance, window and curtain wall systems vary widely. Tubelite does not control the selection of product configurations, operating hardware or glazing materials, and assumes no responsibility thereof.

Optional Details
1/4 scale

OUTSIDE GLAZE

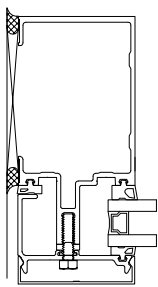

10

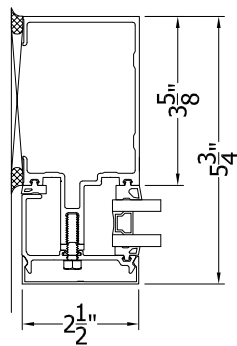

10A

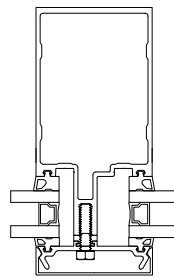

11

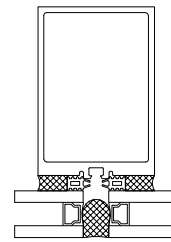

12

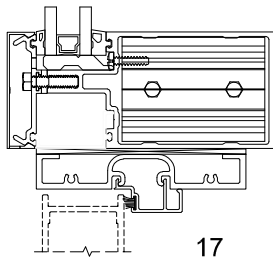

17

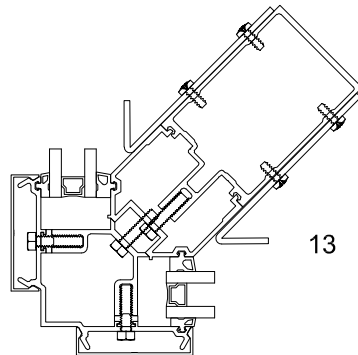

13

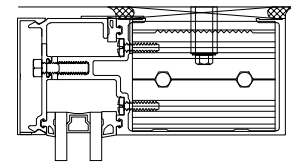

14

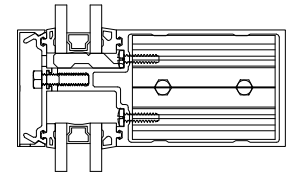

15

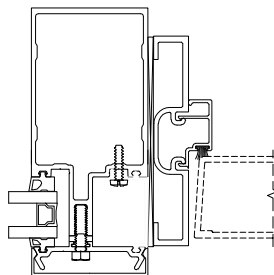

18

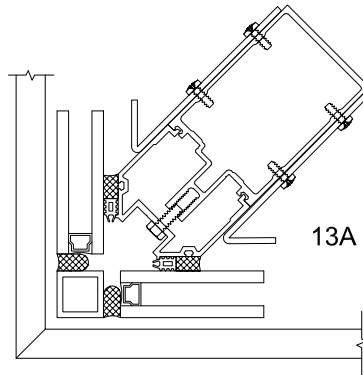

13A

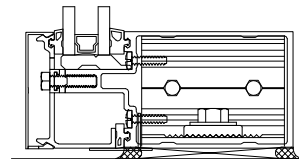

16

TUBELITE[®]
DEPENDABLE
LEADERS IN ECO-EFFICIENT STOREFRONT,
CURTAINWALL AND ENTRANCE SYSTEMS

December 2017

For specific product applications, contact your Tubelite representative. Details on this page represent standard details found on our website. For more options, visit our website at [www.tubeliteinc.com/\[product\]/](http://www.tubeliteinc.com/[product]/)