

# 200 Series Curtainwall

The 200 Series Curtainwall is an economical system with a wide range of low- to mid-rise applications including atriums and clerestory. This exterior-glazed pressure bar system with 2" face dimension is ideal for curving and compatible with all Tubelite entrances.

Snap-on cover finishes, available in a variety of colors, allow for contrasting interior and exterior finishes on exposed framing. Silicone-glazed verticals can be selected to provide a sleek uninterrupted surface.

Both our 200 and 400 Series Curtainwall systems are subjected to rigorous testing by an independent agency, ensuring that you get the highest quality curtainwall products that the industry has to offer.

*200 Curtainwall, T14000 I-O Storefront, Medium Stile Doors, Mountain Tech III, Lindon, UT  
Photographer: Cache Valley Photographers*



**Standard Narrow Stile Entrances**



**14000 I/O Series Multiplane Storefront Framing**

**ALSO USED WITH**

# TUBELITE®

**DEPENDABLE**

LEADERS IN ECO-EFFICIENT STOREFRONT, CURTAINWALL AND ENTRANCE SYSTEMS

# 200 Series Curtainwall

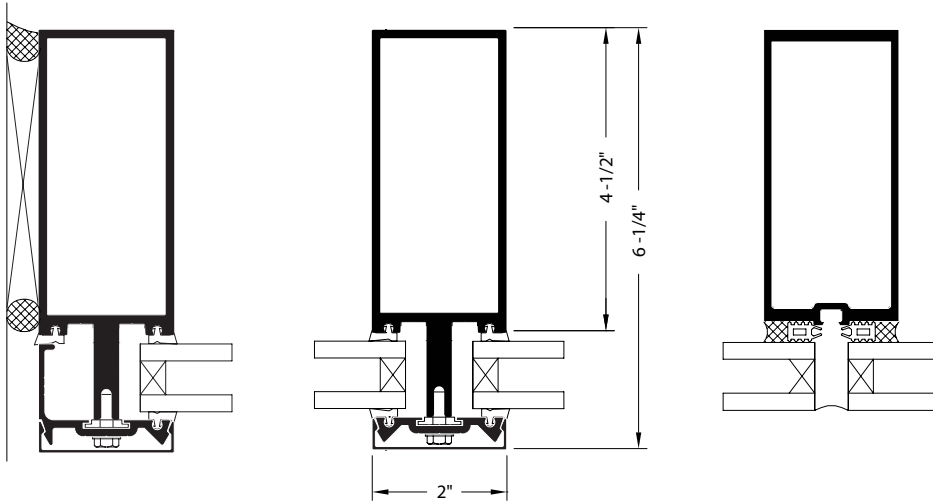

## System Features:

- Standard 4-1/4" (107.95mm) to 8" (203.2mm) depth systems
- 2" (50.8mm) sight line matches Tubelite storefront systems for insulated glass
- Outside glazed pressure-plate system available in captured and structural glazed configurations
- Standard infill option 1" (25.4mm), other infills available
- Thermally Improved using a continuous 1/8" (3.2mm) EPDM Isolator
- Can be shop-fabricated and shop-glazed for labor savings
- Silicone compatible glazing materials for long-lasting seals
- Captured & SSG inside and outside corners available

## Optional Features:

- Steel reinforcing available
- Optional deep profile and bull nose covers available
- Silicone glazed intermediate verticals & horizontals available
- Easily integrates with Tubelite's Entrances, 3700 and Phantom 5000 Insert Vents, and Maxblock Sunshades
- Deep and heavy-weight mullions available

## 200 Series Curtainwall Product Specifications

**Application:** Low and mid-rise commercial buildings including retail, office, healthcare, schools, etc.

**Description:** 2" x 4-1/4" to 8" field glazed, shear block construction curtainwall

Face Width:	Overall Depths:	Glass:	Air Infiltration:	Water Infiltration:	Structural:	U-Factor**:	CRF:	Acoustic:
2"	4-1/4" to 8"	1" (1/8" to 1")	0.06 CFM/Ft.2 @ 6.24 PSF	15 PSF – Static 15 PSF – Dynamic	60 PSF – Design 90 PSF – Overload	0.39 – Captured 0.32 – SSG	68	32 STC 26 OITC

\*\* U-Factor per NFRC 100: COG = 0.24 with warm edge spacer, 1-3/4" x 4-1/2" non-thermal frame.

Refer to the U-Factor table at: [www.tubeliteusa.com/products/curtainwall/200-series-curtainwall/](http://www.tubeliteusa.com/products/curtainwall/200-series-curtainwall/) for other glass makeups and configurations.

DISCLAIMER: Tubelite takes no responsibility for product selection or application, including, but not limited to, compliance with building codes, safety codes, laws, merchantability or fitness for a particular purpose; and further disclaims all liability for the use, in whole or in part, of this Technical Guide in preparation of project specifications and/or other documents. Technical Guides are subject to change at any time, without notice, and at Tubelite's sole discretion. ©2024 Tubelite

092120

# TUBELITE®

**DEPENDABLE**